



The Setter of National Standard of Roll-fed Square Bottom Paper Bag Machine

卷筒纸方底制袋机国家标准制定单位

JianShe **FANGBANG** **HANCENT**

请认准“JianShe”品牌和“FANGBANG”商标
Please recognize "JianShe" brand and "FANGBANG" trademark



HEADQUARTER
Jiangsu Fangbang Machinery Co., Ltd.
江苏方邦机械有限公司(总部)

No. 999 Chengbo Road,
Xiangcheng District, Suzhou China
苏州市相城经济开发区澄波路999号



NEW PRODUCTION BASE
Zhejiang Hancent Technology Co., Ltd.
浙江汉辰科技有限公司(新生产基地)

No. 8 Xinbin Road,
Binhai New District, Pingyang County, Zhejiang China
浙江省温州市平阳县滨海新区新滨路8号

总机 Consulting Hotline: +86-512-65791888
国内业务部 Domestic Sales: +86-512-65791555
国际业务部 International Sales: +86-512-65798803
售后服务部 Service Hotline: +86-512-65798823
图文传真 Fax: +86-512-65791666
邮箱 E-mail: sales@fangbang.cn

国内业务部 Sales Hotline: +86-512-65791555
国际业务部 International Sales: +86-512-65798803
传真 Fax: +86-512-65791666
邮箱 E-mail: sales@fangbang.cn

www.fangbang.cn
www.jian-she.cn



Craftsmanship Spirit
for 45 Years
匠心, 45年不变

江苏 方邦集团





中国卷筒纸方底制袋机国家标准主持制定单位

江苏省首台(套)重大装备-单张纸全自动方底制袋机制造单位

The Setter of National Standard of Roll-fed Square Bottom Paper Bag Machine

The Manufacture Organization of Jiangsu Province First Great Equipment (Fully Auto Sheet-fed Paper Bag Machine)

江苏方邦集团控股有限公司，始创于1990年。集团目前拥有江苏方邦机械有限公司(总部)和浙江汉辰科技有限公司(新生产基地)两大工厂，以印刷包装机械为主要产品，为全世界的客户提供最优质的印刷包装生产解决方案。

方邦集团配备世界顶级加工设备-多轴联动&车铣复合CNC数控加工设备，包括德国德玛吉(DMG MORI)，西班牙尼古拉斯(Nicolas Correa)，韩国斗山(Doosan)等等，同时实验室配有德国蔡司(ZEISS)三坐标等检测设备，有效保证了零配件的加工精度和检测精度，从而确保了设备的整体可靠性和运行稳定性。

经过三十年的刻苦钻研，方邦集团已经拥有120多项专利、16项软件/作品著作权，并通过多项管理体系认证，包括GB/T19001-2016/ISO9001:2015国际质量体系认证、GB/T29490:2013知识产权管理体系认证等等，且产品均通过欧盟CE认证。

方邦集团的客户遍布全世界，包括东南亚、中东、欧洲、美洲、澳洲和非洲等等。众多知名品牌的供应商也选择方邦的设备，为肯德基(KFC)、麦当劳(McDonald's)、星巴克(Starbucks)、瑞幸(Luckin Coffee)、安踏(Anta)优衣库(Uniqlo)等公司提供印刷和纸袋产品。

方邦人秉持技术领先、品质第一的理念，凭借勤奋专注的工匠精神，为客户提供最优质的产品和服务。“做客户信赖的朋友”是我们的宗旨，“为客户创造价值”是我们的目标。“JianShe”牌产品是您最明智的选择。方邦公司竭诚欢迎国内外新老客户与我们真诚合作，共创双赢。

Jiangsu Fangbang Group was founded in 1990, which has 2 fully owned subsidiaries, including Jiangsu Fangbang Machinery Co., Ltd. (Headquarter) and Zhejiang Hancent Technology Co., Ltd. (New Production Base). By supplying printing machines and packaging machines, Fangbang Group strives to offer the best production solutions to various printing and packaging requirements of the customers all over the world.

Fangbang Group is equipped with world-class Multi-axis & Turning-Milling Compound processing equipment, including German DMG MORI, Spanish Nicolas Correa, Korean Doosan and so on. Meanwhile the laboratory is equipped with Zeiss 3-coordinate measuring machine and other inspecting machines, so that we can ensure the processing and inspecting Accuracy of spare parts, to obtain overall reliability and operational stability.

After 30 years devotion on research, Fangbang Group has gained more than 120 patents and 16 software/work copyrights, and has passed GB/T19001-2016/ISO9001:2015 International Quality System Certification, GB/T 29490:2013 Intellectual Property Management System Certification, etc., and all products are certified by CE.

The customers of Fangbang Group are from countries/regions all over the world, including South-east Asia, Middle East, Europe, America, Australia and Africa. And they use our machines to offer printing and bags to many internationally famous brands, such as KFC, McDonald's, Starbucks, Luckin Coffee, Anta and Uniqlo, etc.

Fangbang team insists on the concept of technology leading and quality first to offer the best products and service to customers. "Be dependable friend of customers" is our purpose, "Create value for customers" is our goal. "JianShe" brand products are your best choice: we sincerely welcome old and new customers to cooperate with Fangbang and make progress together.



总部 Headquarter

江苏方邦机械有限公司是一家位于中国江苏省苏州市，集研发、生产、销售和服务于一体的高新技术企业，专业生产方底纸袋机系列(单张纸、卷筒纸、全自动和半自动)产品。公司占地40亩，总建筑面积超过3万平方米。公司拥有进出口自营权，在内外设立了三十多个办事处确保为用户提供强有力的技术支持和快捷的售后服务。

Jiangsu Fangbang Machinery is a high-tech enterprise including research and development, production, sales and service, located in Suzhou China, covering an area more than 30,000 square meters. This company is specialized in the production of paper bag making machines (sheet paper feeding, roll paper feeding, full-automatic, semi-automatic and so on. Our company has the right to import and export. Now we have more than 30 offices in China and abroad, and have established a perfect after-sales service system to ensure that we can provide strong technical support and attentive, efficient service for customers.

新生产基地 New Production Base

浙江汉辰科技有限公司，作为方邦集团的全新生产基地，坐落于中国浙江省温州市，于2022年3月份正式投入使用。浙江汉辰占地60亩，总建筑面积超过10万平米，主要研发和生产阀口袋制袋机，纸袋机和柔版印刷机，实现了单厂年产300台纸袋机的能力，与江苏方邦一起，为全球客户提供更加优质的产品和更加完善的服务。

Zhejiang Hancent Technology is located in Wenzhou China, and was officially put into use in March 2022. As the new production base of Fangbang group, it has 7 buildings and covers an area more than 100,000 square meters. In this factory we are committed to the research and production of valve sack machines, paper bag machine and flexo printing machines. With the ability of annual production capacity of 300 paper bag machines, Hancent will work together with Jiangsu Fangbang to provide global customers with more perfect products and services.

江苏方邦机械有限公司(江苏·苏州)
Jiangsu Fangbang Machinery (Suzhou • Jiangsu)



浙江汉辰科技有限公司(浙江·温州)
Zhejiang Hancent Technology (Wenzhou • Zhejiang)



WHY CHOOSE JIANGSU FANGBANG?

为什么选择江苏方邦?



WE WALKED EVERY STEP ATTENTIVELY AND LEFT TRACES

我们用心走每一个足迹



FANGBANG 销售额年均增长率
Average annual sales growth rate

+32%

一直 引领行业

HAS BEEN LEADING THE INDUSTRY

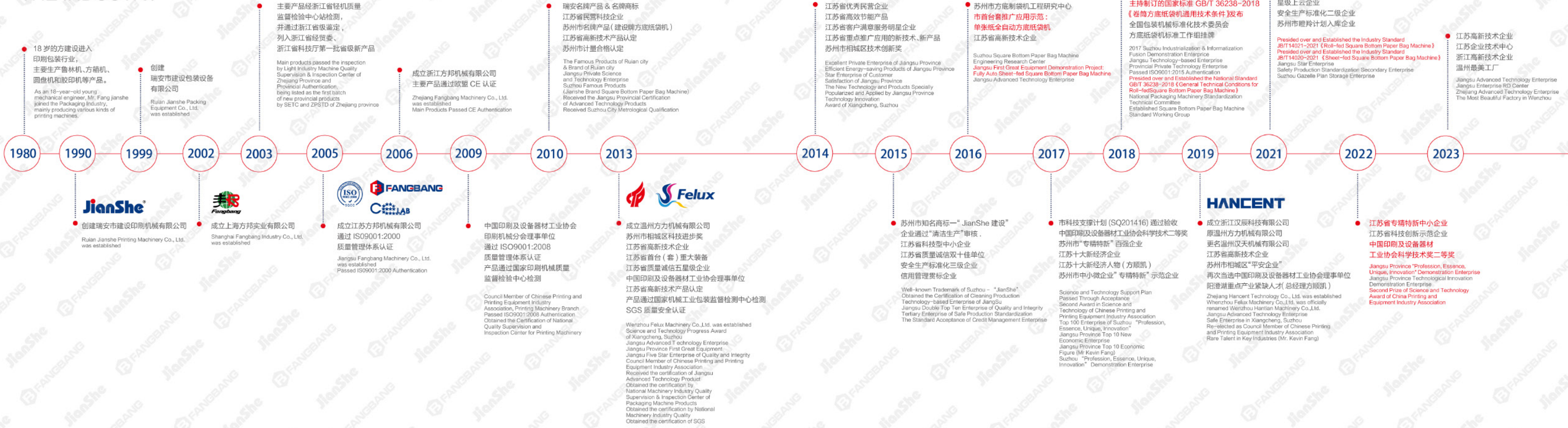

生产车间 PRODUCTION WORKSHOP

We insist on the concept of
"Technology Leading & Quality First"

我们始终坚持 " 技术领先,
质量第一 " 的理念

客户工厂 CLIENTS' FACTORIES

The purpose of fangbang team
is to create more values for customers

方邦人的宗旨:
为客户创造更多价值

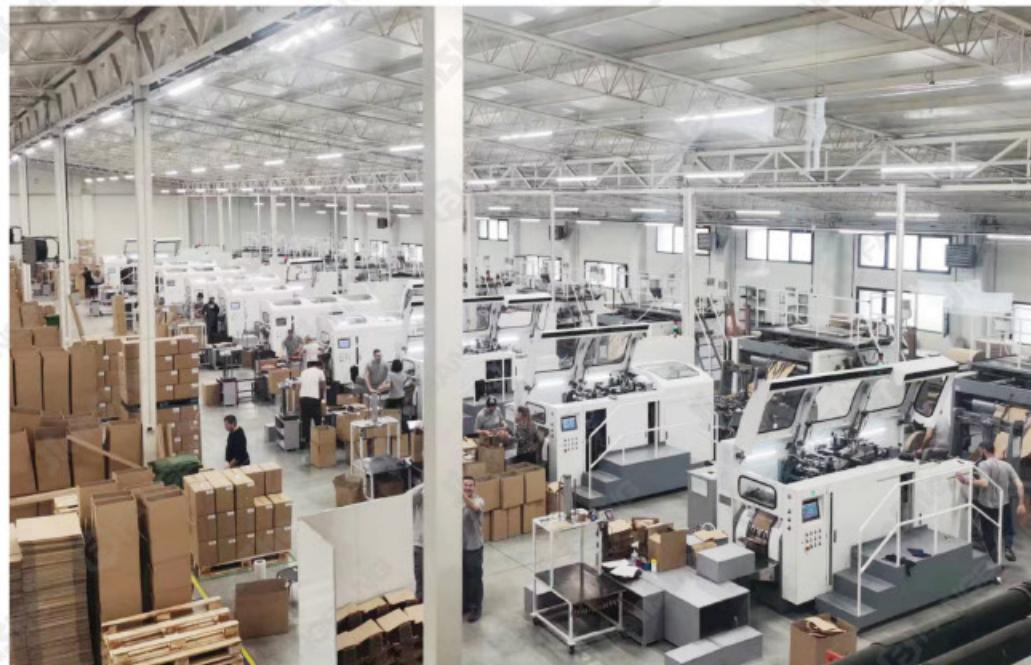

无论您有什么样的需求
方邦都能提供最完美的解决方案

Whatever you required,
Fangbang can supply all the most perfect solutions

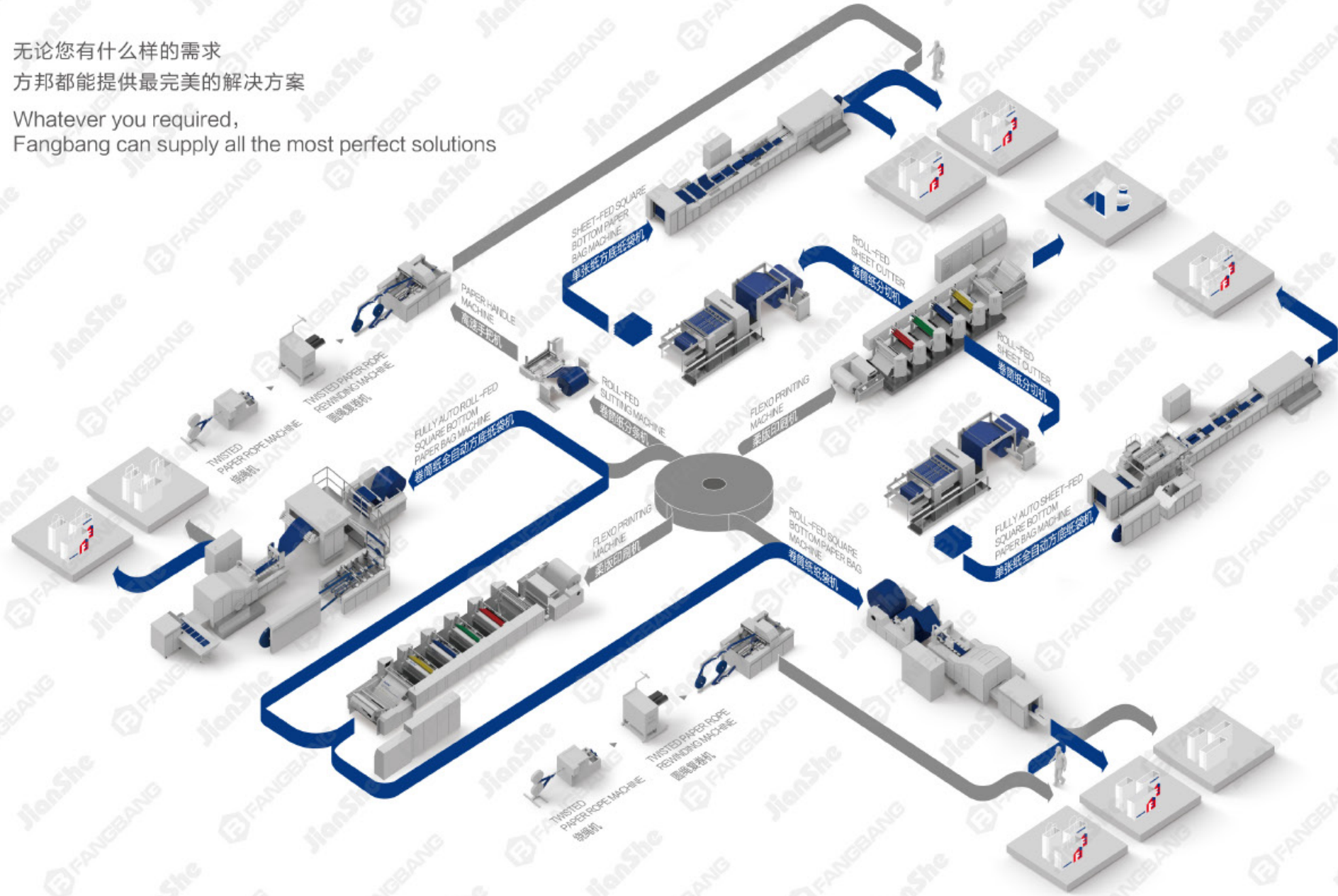

类型 Categories	单张纸袋机 Sheet-fed Paper Bag Machine	卷筒纸袋机 (全自动) Roll-fed Paper Bag Machine (Fully Auto)	卷筒纸袋机 (半自动) Roll-fed Paper Bag Machine (Semi Auto)	柔版印刷机 Flexographic Printing Machine	辅助设备 Auxiliary Equipments
	03 ZD-QFP 单张纸全自动方底纸袋机 Fully Auto Sheet-fed Square Bottom Paper Bag Machine	19 ZD-QFB 卷筒纸全自动方底纸袋机(扁绳) Fully Auto Roll-fed Square Bottom Paper Bag Machine with Flat Handle	35 ZD-J20S/D 全伺服高速尖底纸袋机 Full-servo High Speed Flat Bottom Paper Bag Machine	51 YT-E★ 高速机组式柔版印刷机 High Speed Unit-type Flexo Printing Machine	65 ZD-SB100 高速手把机 High Speed Paper Handle Machine
	08 ZD-QFP08/14/18/18S/20★	22 ZD-QFB11/13E[S]/14/18C/21	37 ZD-J10/13 卷筒纸尖底纸袋机 Roll-fed Flat Bottom Paper Bag Machine	53 YT-D 机组式柔版印刷机 Unit-type Flexo Printing Machine	67 ZD-YS300 绕绳机 Twisted Paper Rope Machine
	09 ZD-BFP 单张纸自动方底纸袋机 Auto Sheet-fed Square Bottom Paper Bag Machine	23 ZD-QFF14★ 双层卷筒纸全自动(扁绳)方底纸袋机 Dual-layer Fully Auto Roll-fed Square Bottom Paper Bag Machine with Flat Handle	39 ZD-FJ06 高速单规格方底纸袋机 Fast Fixed-size Square Bottom Paper Bag Machine	57 YT-CB★ 双伺服机组式柔版印刷机 Dual-servo Unit-type Flexo Printing Machine	68 ZD-FJ200 圆绳复卷机 Twisted Paper Rope Rewinding Machine
	12 ZD-BFP08/18/20	25 ZD-QFJ 卷筒纸全自动方底纸袋机 Fully Auto Roll-fed Square Bottom Paper Bag Machine	41 ZD-FJ 卷筒纸方底纸袋机 Roll-fed Square Bottom Paper Bag Machine	59 YT-BE 层叠式柔版印刷机 Stack-Type Flexo Printing Machine	69 FQ-1400/1700/1900 卷筒纸分切机 Roll-fed Sheet Cutter
	13 ZD-FP 单张纸方底纸袋机 Sheet-fed Square Bottom Paper Bag Machine	30 ZD-QFJ08[T]/11E/13E[S]/14/18C/21	44 ZD-FJ08/11E/13E[S]/18B[C]/21	60 YT-BC 层叠式柔版印刷机 Stack-Type Flexo Printing Machine	70 FT-1300/1800 卷筒纸分条机 Roll-fed Slitting Machine
	16 ZD-FP08/14/18/20	31 ZD-QFJ18N★ 全伺服卷筒纸全自动方底纸袋机 Fully Auto Roll-fed Square Bottom Paper Bag Machine (Full-servo)	45 ZD-FJ+T+D+W+P 卷筒纸方底纸袋机(多功能选配) Roll-fed Square Bottom Paper Bag Machine (Multi-functional Options)	61 YT-ZB 视频装版机 Visual Plate Mounting Machine	
			47 ZD-FJ21+PE+S/ZD-FJ21+PC★ 卷筒纸快递纸袋机 Roll-fed E-commerce Paper Bag Machine	62 YT-WQ 网纹辊超声波清洗机 Anilox Roller Ultrasonic Cleaning Machine	
用途 Usage	精品袋 Luxury Bags	快消品购物袋 FMCG Shopping Bags	食品包装袋 Food Bags	纸张, 无纺布印刷 Printing on Paper or Nonwoven Fabrics	与纸袋机配套 Supporting Paper Bag Machines



单张纸袋机

SHEET-FED PAPER BAG MACHINE

适用于精品袋
Applicable for Luxury Bags



他们都在使用我们机器生产的纸袋

They are all using the paper bags produced by our machines



这，只是其中一小部分

And this, is only a small part of them



ZD-QFP

单张纸全自动方底纸袋机

Fully Auto Sheet-fed Square Bottom Paper Bag Machine

- Sheet Paper 单张纸
- Handle 自动带手把
- Punching 反折打孔
- Top Folding 反折带手把
- W/O Handle 无手把
- Roll Paper 卷筒纸
- Patch Handle 贴手把

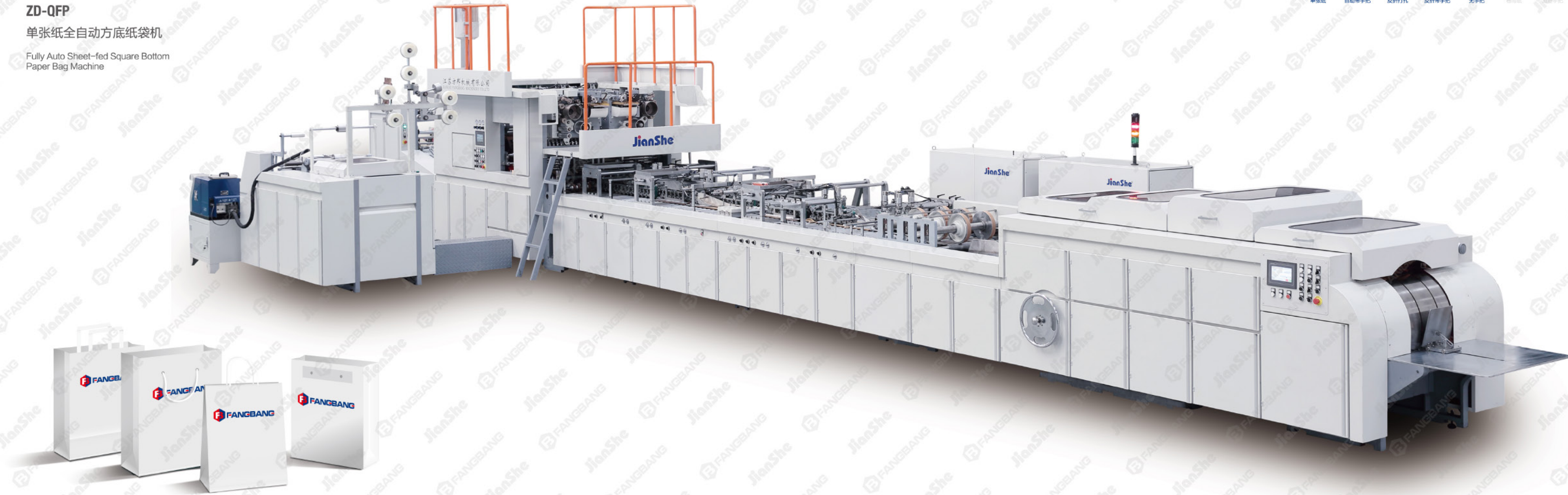

本机以单张纸、卷筒式头卡和纸绳为原料，一次性完成带手把的小型方底纸袋，是生产中高档手提纸袋的理想设备，特别适用于食品、服装和奢侈品等行业的购物袋生产。通过在—台机器上完成手把制作、手把黏贴、袋口反折、纸筒成型和袋底成型等步骤，该机器真正实现了全自动化生产，能够有效节省人工成本。配备了先进的预堆纸飞达，能够实现不停机送纸，从而提高了机器产能。得益于完美的工艺，本机能够生产出多种不同形式的高质量手提纸袋，彻底解放小型方底手提袋制作者的双手，为客户带来更多的利润。

This machine is designed to manufacture small-sized square bottom paper bags with handles from sheet paper, paper patch roll and paper rope, and it is an ideal equipment for producing mid-to-high-end paper handbags, especially suitable for food, clothing and luxuries industries. By implementing steps including handle making, handle application, bag mouth folding, tube forming and bottom forming within a fully automatic process, this machine can effectively save labor costs. Equipped with advanced pre-heap paper feeder, this machine can realize non-stop feeding, thereby improving the production capacity. Thanks to perfect technologies, the machine can produce paper handbags with high quality in many different forms, thoroughly liberate the hands for making small-sized paper handbags, and bring more profit for the customer.

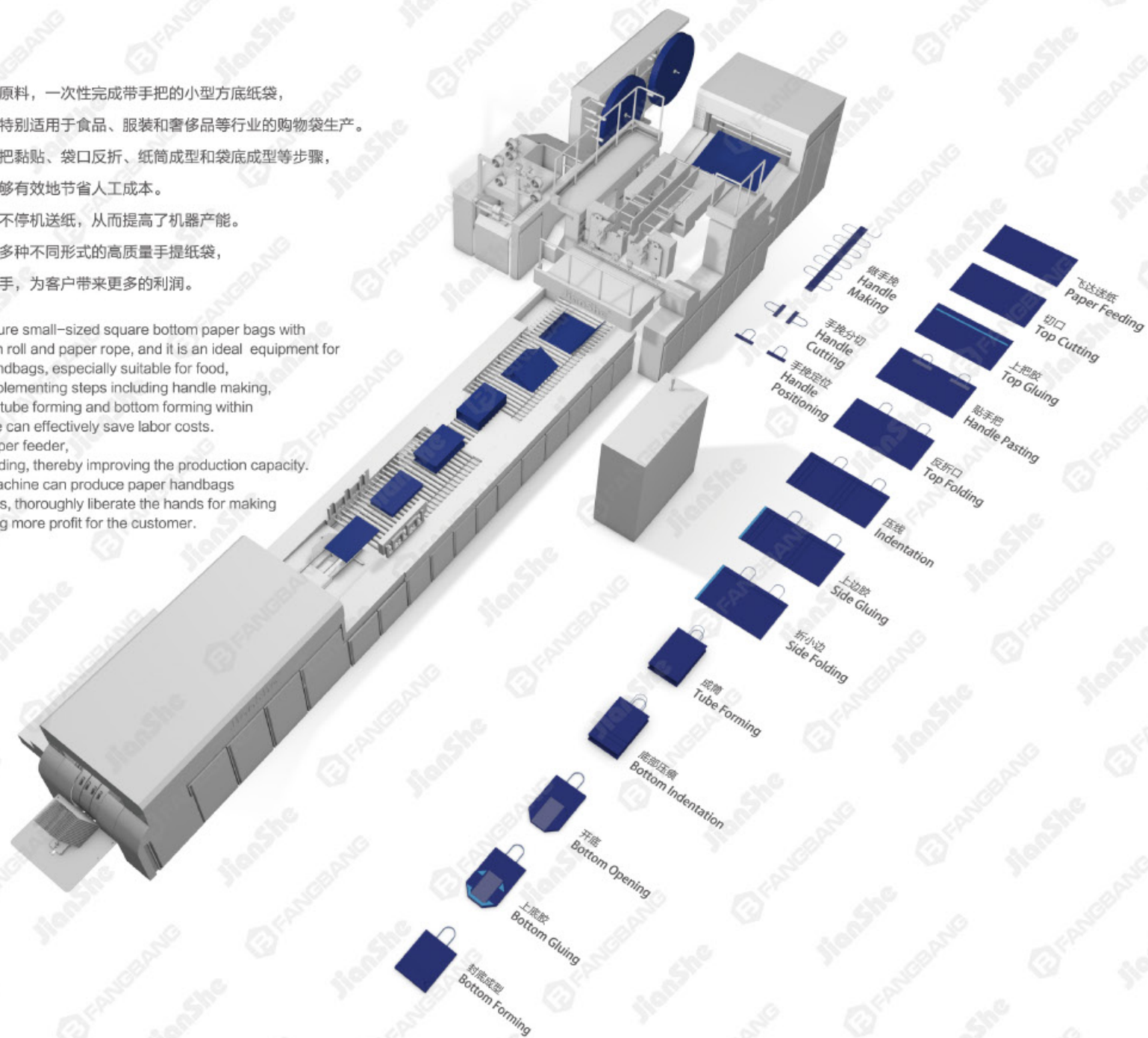

该机器能根据客户的需求，将多种形式的纸张（包括牛皮纸，铜版纸和覆膜纸等等）制作成 3 种不同的手提纸袋。

This machine can make 3 different kinds of paper bags, according to customers' various requirements, from various kinds of paper, including kraft paper, coated paper and laminated paper, etc.

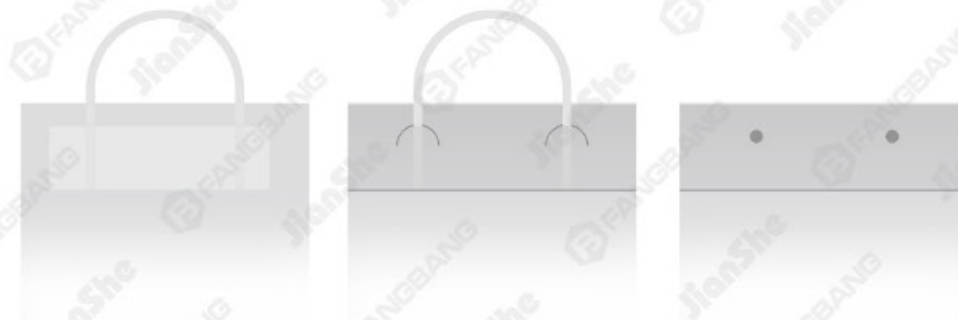

可选配的剪刀夹和拨动夹系统，使得机器可以轻松处理薄纸和厚纸（拨动夹系统可以处理 250gsm 的部分纸张）。

Optional scissor clamp system and toggle clamp system, bring machines the advantage of coping with thin paper as well as thick paper (toggle clamp system can process some kind of paper with thickness 250gsm).



剪刀夹系统 (scissor clamp system)



拨动夹系统 (toggle clamp system)

可选配的纸筒传输系统（皮带式和滚轮式），实现对不同纸张的各式制袋工艺要求。

Optional transfer systems (belt-type and roller-type) for tube forming, meet requirements of different paper bag making processes for various kinds of paper.

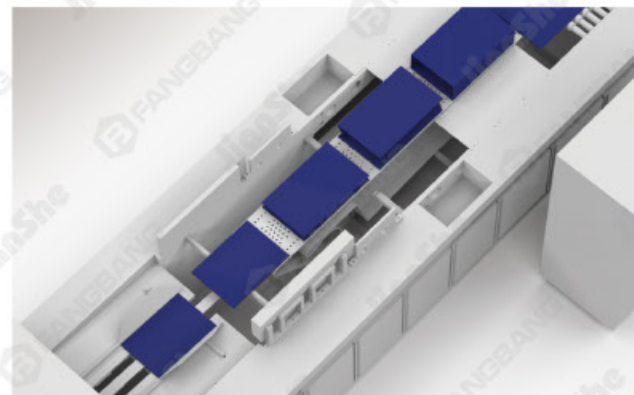

皮带式传动 (belt-type transfer)

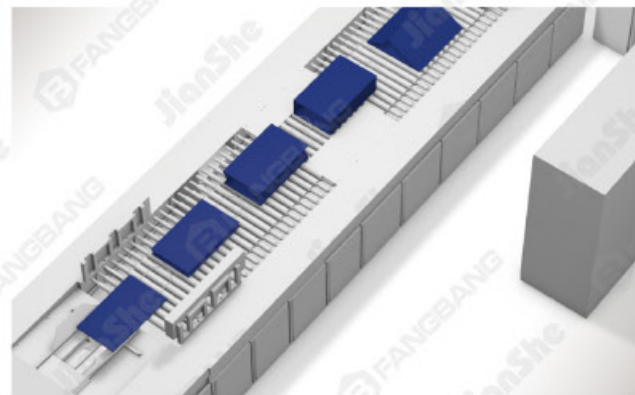

滚轮式传动 (roller-type transfer)

特殊的定制机型设计，大幅提升机器的制袋范围和客户的接单范围（可选配大小边粘合装置；袋宽可达 500mm 或底宽可达 250mm）。

Special customized model design enlarges the production range of machines as well as the business range of customers (optional big/small side pasting device; bag width can reach 500mm or bottom size can reach 250mm).

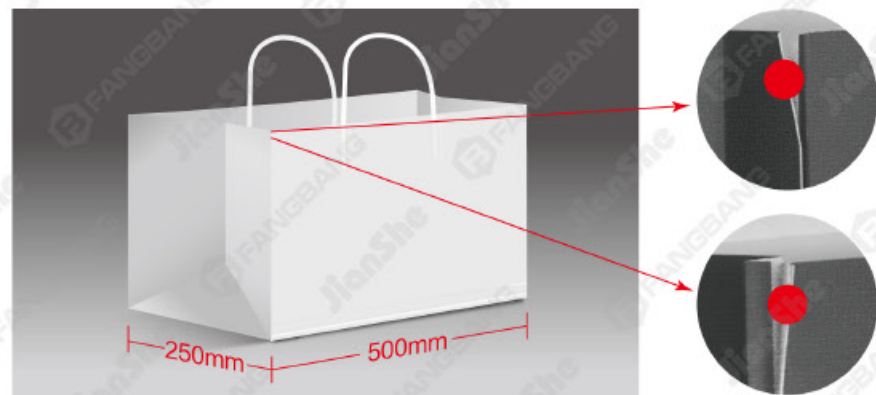

可选配的扁绳手把单元，为客户提供更多的制袋选择，为传统的快消购物纸袋行业带来“无折痕”革命；

可额外选配伺服电机，代替传统传动轴驱动，有效降低材料损耗和人工成本。

Optional flat handle unit, brings more choices for bag making to customers and "non-creased" revolution to traditional shopping bag industry of Fast Moving Consumer Goods; optional servo motor, can replace traditional driving shaft, to efficiently reduce material waste and labor cost.



最新机型的生产速度可达 100 个 / 分，且由同一台手把机生产圆绳和扁绳手把，

更少投资，更多收益。

The latest model can produce paper handbags at the speed 100BPM, where twisted and flat handle can be produced in 1 handle making machine, which bring more profits with less investment.

全球首创 Global First
双倍产能 Double Profits

NEW

TECHNICAL DATA

主要技术参数

		ZD-QFP08	ZD-QFP14	ZD-QFP18	ZD-QFP18S	ZD-QFP20
原纸宽度	Paper Width	470~780mm	550~1050mm	630~1250mm	710~1250mm	710~1320mm
原纸长度	Paper Length	310~530mm	340~630mm	340~630mm	400~630mm	360~630mm
原纸克重	Paper Thickness	100~160g/m ²	100~220g/m ² (250g/m ²)	100~220g/m ² (250g/m ²)	100~220g/m ² (250g/m ²)	100~220g/m ² (250g/m ²)
纸袋宽度	Bag Body Width	135~250mm	180~350mm	220~450mm	240~450mm	240~500mm
纸袋高度	Bag Body Height	215~395mm	200~480mm	200~480mm	280~480mm	200~480mm
袋底宽度	Bag Bottom Size	60~130mm	80~180mm	80~180mm/80~220mm	100~250mm	100~180mm
袋口反折宽度	Bag Mouth Fold Width	35~55mm	40~60mm	40~60mm	40~60mm	40~60mm
手把绳高	Handle Rope Height	155~175mm	170~185mm	170~185mm	170~185mm	170~185mm
手把绳直径	Handle Rope Diameter	Φ4~6mm	Φ4~6mm	Φ4~6mm	Φ4~6mm	Φ4~6mm
手把贴片长度	Handle Patch Length	114.3mm	152.4mm	188.5mm	188.5mm	188.5mm
手把贴片宽度	Handle Patch Width	40~50mm	40~50mm	40~50mm	40~50mm	40~50mm
手把贴片纸卷直径	Paper Patch Roll Diameter	Φ1200mm	Φ1200mm	Φ1200mm	Φ1200mm	Φ1200mm
手把贴片纸卷宽度	Paper Patch Roll Width	80~100mm	80~100mm	80~100mm	80~100mm	80~100mm
手把贴片纸克重	Paper Patch Thickness	100~250g/m ²	100~250g/m ²	100~250g/m ²	100~250g/m ²	100~250g/m ²
最大速度	Max. Speed	100bags/min	100bags/min	100bags/min	80bags/min	100bags/min
机器功率	Total Power	22kw	20kw	22kw	22kw	22kw
机器重量	Total Weight	Approx. 20000kg	Approx. 22000kg	Approx. 24000kg	Approx. 27000kg	Approx. 25000kg
外形尺寸	Overall Dimension	L13500 × W4300 × H2400mm	L16000 × W4300 × H2600mm	L16000 × W4500 × H2600mm	L17500 × W4500 × H2600mm	L16000 × W4600 × H2600mm

生产速度会因纸张和胶水的品质，以及操作人员操作熟练程度而有所不同。
Production speed will be variable due to different paper, glue and operator's skill.

ZD-BFP

单张纸自动方底纸袋机

Auto Sheet-fed Square Bottom Paper Bag Machine

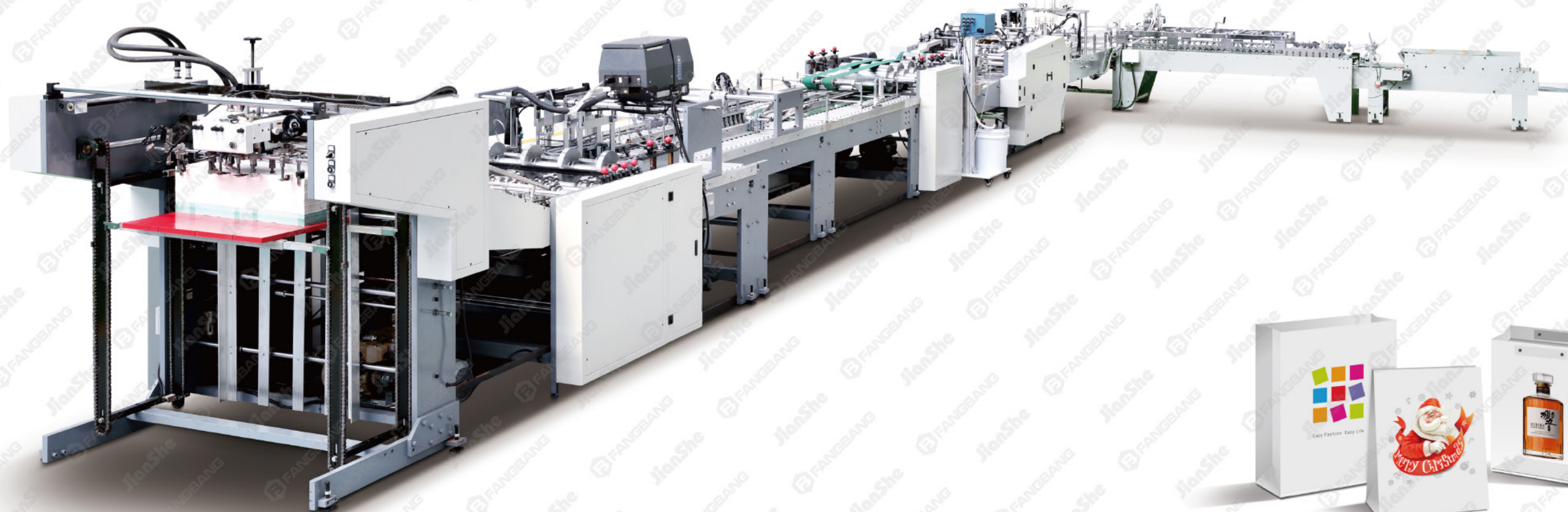

本机以单张纸为原料，一次性完成具有上折口和底卡的方底纸袋，是加工中高档无痕式手提袋的理想设备。

通过在一台机器上完成原纸输送、成筒压线、袋口反折、边胶涂抹、纸筒成型、

纸袋翻转、袋底成型、插底卡和袋底封合等步骤，该机器能够在保证手提袋成型质量的同时有效地减少人工成本。

配备了先进的预堆纸飞达，能够实现不停机送纸，从而提高机器产能。

特殊的机械和电气设计，让本机能够处理各种纸张，

可以满足食品、服装和奢侈品等不同行业的购物袋生产需要。

This machine is designed to manufacture square bottom paper bags with top folding and bottom cardboard inserting from sheet paper, and it is an ideal equipment for processing mid-to-high-end trackless paper handbags. By implementing steps including paper feeding, line imposing, top folding, side gluing, tube forming, bag turnover, bottom forming, bottom cardboard inserting and bottom closing inline, this machine can effectively ensure high-quality paper bags as well as save labor costs. Equipped with advanced pre-heap paper feeder, this machine can realize non-stop feeding, thereby improving the production capacity. Special mechanical and electrical patented designs ensure that the machine can process various kinds of paper, thus being able to produce different excellent paper bags, which are especially suitable for food, clothing and luxuries industries.

特殊的袋口反折设计，使得机器可以制作3种袋口，大幅提升客户的接单范围，为客户带来更多利润。

Special patented design for top folding enables the machine to make 3 different kinds of bag mouths, so as to greatly enlarge business range of customers and bring more profits to customers.



标新立异的自动放底卡功能，能够有效地加强纸袋的承重能力，并减少客户的用工成本。

Unconventional bottom cardboard inserting function can effectively strengthen weight capacity of paper bags and reduce labor cost of customers.

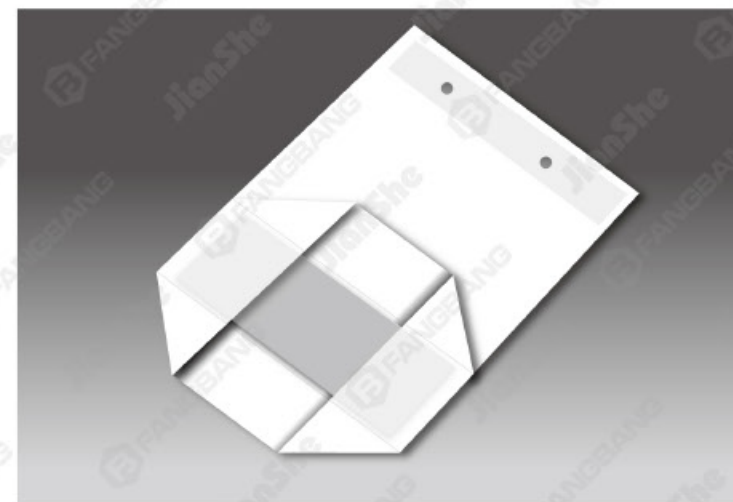

TECHNICAL DATA

主要技术参数

		ZD-BFP08	ZD-BFP18	ZD-BFP20
原纸宽度	Paper Width	390-780mm	550-1250mm	710-1320mm
原纸长度	Paper Length	310-530mm	310-630mm	340-630mm
原纸克重	Paper Thickness	A: 牛皮纸 120-200g/m ² B: 铜版纸+PP覆膜 155-250g/m ² C: 白卡+PP覆膜 180-250g/m ² D: 灰板纸+PP覆膜 150-300g/m ²	A: (Kraft Paper) 120-200g/m ² B: (Art Paper)+(Laminated PP Film) 155-250g/m ² C: (White Cardboard)+(Laminated PP Film) 180-250g/m ² D: (Grey paperboard)+(Laminated PP Film) 150-300g/m ²	
纸袋宽度	Bag Body Width	120-250mm	180-450mm	240-500mm
纸袋高度	Bag Body Height	215-395mm	240-480mm	250-480mm
袋底宽度	Bag Bottom Size	60-130mm	80-170mm	100-170mm
袋口反折宽度	Bag Mouth Fold Width	25-50mm	25-50mm	25-50mm
最大速度	Max. Speed	40-60bags/min	40-60bags/min	40-60bags/min
机器功率	Total Power	12kw	15kw	15kw
机器重量	Total Weight	10000kg	15000kg	15000kg
外形尺寸	Overall Dimension	L17300 × W2200 × H1700mm	L17300 × W2500 × H1700mm	L17300 × W2600 × H1700mm
贴底卡外形尺寸	Overall Dimension of Bottom Card Device		L 2800 × W1500 × H1600mm	L2800 × W1500 × H1600mm

生产速度会因纸张和胶水的品质，以及操作人员操作熟练程度而有所不同。
Production speed will be variable due to different paper, glue and operator's skill.

ZD-FP

单张纸方底纸袋机

Sheet-fed Square Bottom
Paper Bag Machine



本机以单张纸为原料，一次性完成无手把的方底纸袋，是加工中高档手提纸袋的理想设备。

通过在一台机器上完成原纸输送、成筒压线、边胶涂抹、纸筒成型和袋底成型等步骤，

该机器能够在保证手提袋成型质量好的同时有效地减少人工成本。

配备了先进的预堆纸飞达，能够实现不停机送纸，从而提高了机器产能。

完美的水胶和热熔胶上胶装置，让本机能够处理多种纸张，

可以充分满足食品、服装和奢侈品等不同行业的购物袋生产需要。

This machine is designed to manufacture square bottom paper bags without handles from sheet paper, and it is an ideal equipment for processing mid-to-high-end paper handbags. By implementing steps including paper feeding, line imposing, side gluing, tube forming and bottom forming inline, this machine can effectively ensure high-quality paper bags as well as save labor costs. Equipped with advanced pre-heap paper feeder, this machine can realize non-stop feeding, thereby improving the production capacity. Perfect water glue and hot-melt glue application devices ensure that the machine can process various kinds of paper, thus being able to produce different excellent paper bags, which are especially suitable for food, clothing and luxuries industries.

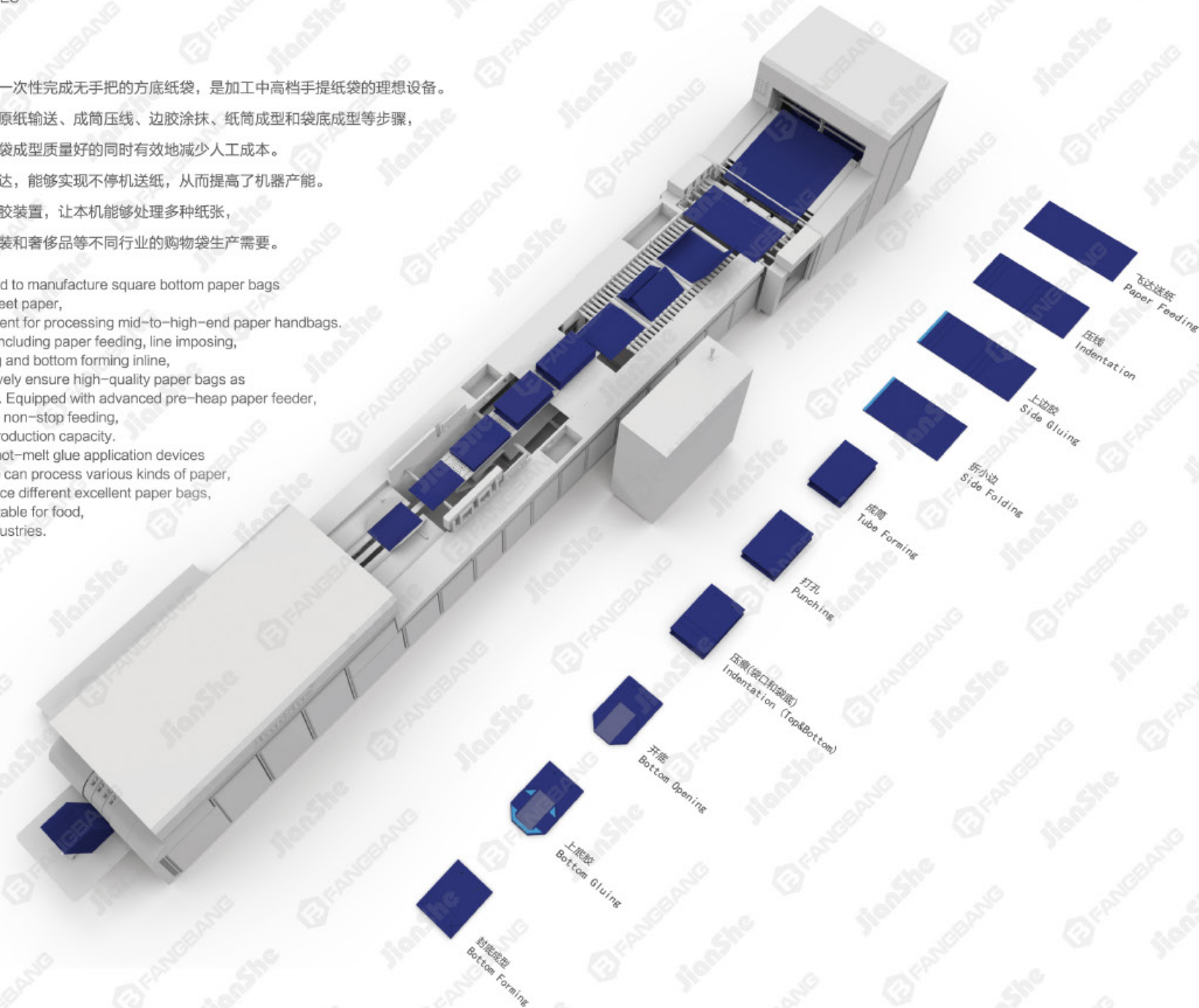

该机器能根据客户的需求制作 2 种不同的无手把纸袋。

This machine can make 2 different kinds of paper bags without handles according to customers' various requirements.



该机器可以处理多种形式的纸张，

比如牛皮纸、双胶纸、铜版纸和白卡纸（包括覆膜的纸张）等等。

The machine can process various kinds of paper, such as kraft paper, woodfree paper, coated paper and ivory board (including laminated paper), etc.



TECHNICAL DATA

主要技术参数

		ZD-FP08	ZD-FP14	ZD-FP18	ZD-FP20
原纸宽度	Paper Width	400~780mm	550~1050mm	630~1250mm	710~1320mm
原纸长度	Paper Length	310~530mm	340~630mm	340~630mm	360~630mm
原纸克重	Paper Thickness	100~160g/m ²	100~250g/m ²	100~250g/m ²	100~250g/m ²
纸袋宽度	Bag Body Width	120~250mm	180~350mm	220~450mm	240~500mm
纸袋高度	Bag Body Height	215~395mm	200~480mm	200~480mm	200~480mm
袋底宽度	Bag Bottom Size	60~130mm	80~180mm	80~180mm	100~180mm
最大速度	Max. Speed	80bags/min	80bags/min	80bags/min	80bags/min
机器功率	Total Power	12kw	13kw	15kw	15kw
机器重量	Total Weight	Approx. 10000kg	Approx. 11000kg	Approx. 12000kg	Approx. 14000kg
外形尺寸	Overall Dimension	L13500 × W2400 × H1600mm	L13000 × W2400 × H1700mm	L13000 × W2500 × H1700mm	L13500 × W2500 × H1700mm

生产速度会因纸张和胶水的品质，以及操作人员操作熟练程度而有所不同。
Production speed will be variable due to different paper, glue and operator's skill.



卷筒纸袋机 (全自动)

ROLL-FED PAPER BAG MACHINE (FULLY AUTO)

适用于快消品购物袋

Applicable for FMCG Shopping Bags



他们竭尽全力去追逐这个世界的潮流

They try best to chase the tide of this world

而方邦的环保纸袋，才是引领世界的未来潮流

And the environmental paper bags from Fangbang,
must lead the trend of future

ZD-QFB

卷筒纸全自动(扁绳)方底纸袋机

Fully Auto Roll-fed Square Bottom Paper Bag Machine with Flat Handle

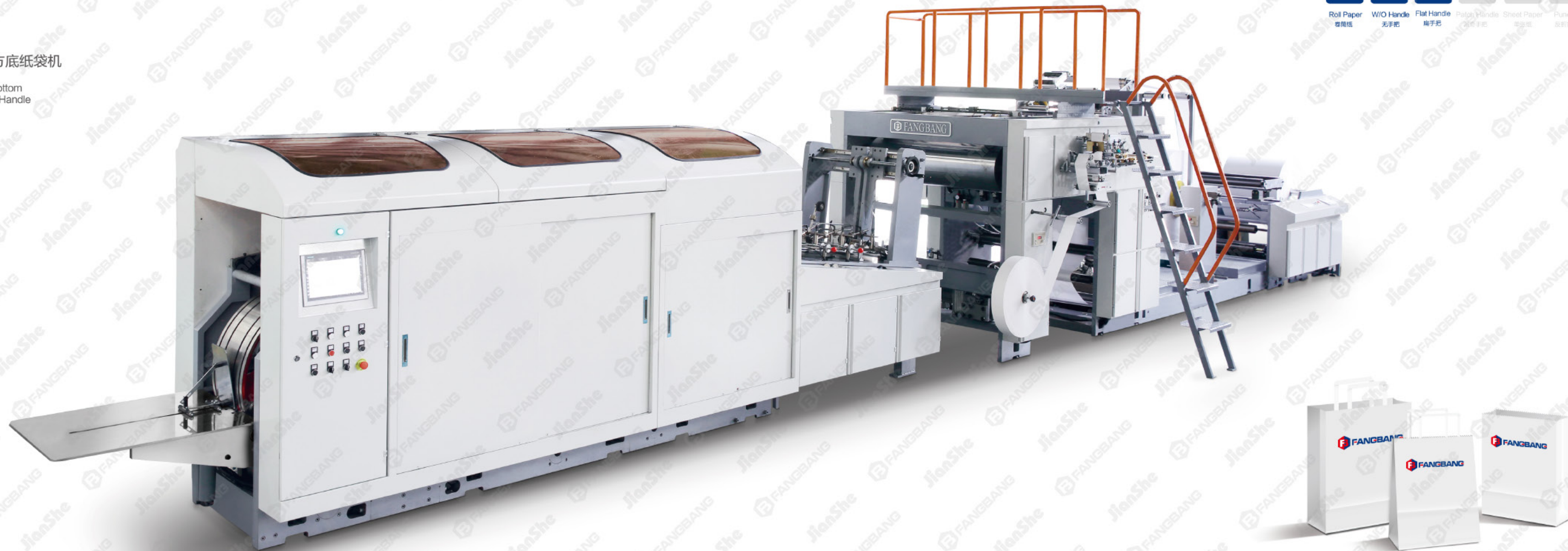

本机以卷筒纸、卷筒式头卡和扁绳纸卷为原料，一次性完成带扁绳手把的方底纸袋，是快速生产扁手提纸袋的理想设备。

通过一次性完成手把制作、手把黏贴、纸筒成型、纸筒切断和袋底成型等步骤，该机器真正实现了全自动化生产，能够有效地节省人工成本。

与众不同的扁绳手把制作工艺和特殊的成品计数功能，有效提高了用户批量打包成品的效率。

得益于完美的工艺和快速的制袋速度，本机特别适用于食品和服装等行业的购物袋批量生产。

This machine is designed to manufacture square bottom paper bags with flat-rope handles from paper roll, paper patch roll and flat handle paper roll, and it is an ideal equipment for producing paper handbags fast. By implementing steps including handle making, handle application, tube forming, tube cutting and bottom forming within a fully automatic process, this machine can effectively save labor costs. Distinct flat-rope handle making process and special bag counting function, greatly improve packing efficiency of finished paper bags. Thanks to perfect technologies and fast production speed, this machine can produce paper handbags with high quality in many different forms, which are especially suitable for food and clothing industries.

ZD-QFB14 的 5 等分成底大轂，使得其生产速度要明显高于其他相似的传统机型。

The bottom forming hub of ZD-QFB14 makes 5 paper bags by 1 round, which brings apparently higher speed than other similar traditional models.



采用西门子 PLC 系统控制整机运行，

可以在触摸屏上直接调整切断长度，让生产更加高效和稳定。

SIEMENS PLC system ensures that the adjustment of cutting length can be implemented directly on touch screen, meanwhile brings efficient and stable production.



通过直接在纸面上制作扁绳手把，客户不仅可以不再依赖传统的外置手把机，而且可以节省 50% 的贴片纸张。

此外，在同一台机器上可以实现扁绳内折或外翻，帮客户在传统用袋习惯和高效包装运输之间找到完美平衡。

By directly making flat-rope handles on paper web, customers can not only no longer rely on the traditional external hand making machine, but also be able to save 50% patch paper. Moreover, it can make folded or unfolded flat handle in the same machine, assisting users to balance traditional bag-using habit with highly effective packaging and transportation.



TECHNICAL DATA

主要技术参数

	ZD-QFB11	ZD-QFB13E[S]	ZD-QFB14[S]	ZD-QFB18P	ZD-QFB21S[M]	
纸卷宽度	Paper Roll Width	590~890mm(370~890mm)	590~990mm(400~990mm)	590~1150mm	630~1390mm(590~1390mm)	630~1530mm[690~1710mm]
最大纸卷直径	Max. Paper Roll Diameter	Φ1500mm	Φ1500mm	Φ1500mm	Φ1500mm	Φ1500mm
基材卷芯内径	Material Core Diameter	Φ76mm(3")	Φ76mm(3")	Φ76mm(3")	Φ76mm(3")	Φ76mm(3")
原纸克重	Paper Thickness	70~160g/m ²	70~160g/m ²	70~150g/m ²	80~160g/m ²	80~150g/m ²
纸袋宽度	Bag Body Width	180~280mm(110~280mm)	200~330mm(125~330mm)	200~360mm	220~460mm(200~460mm)	220~540mm
纸筒长度	Paper Tube Length	270~530mm	270~530mm	350~650mm	350~620mm(280~620mm)	400~720mm(380~770mm)
袋底宽度	Bag Bottom Size	60~150mm	60~150mm[70~180mm]	80~200mm[100~230mm]	80~220mm	80~254mm[110~300mm]
扁绳手把高	Flat Handle Rope Height	75mm	75mm	75mm	90mm	90mm
扁绳宽度	Flat Handle Rope Width	10mm	13mm	13mm	16mm	16mm
扁绳纸卷宽度	Paper Rope Roll Width	78mm	101mm	101mm	93mm	93mm
扁绳纸卷直径	Paper Rope Roll Diameter	Φ1200mm	Φ1200mm	Φ1200mm	Φ1200mm	Φ1200mm
扁绳纸克重	Paper Rope Thickness	70~100g/m ²	70~100g/m ²	70~100g/m ²	70~100g/m ²	70~100g/m ²
手把贴片长度	Handle Patch Length	160mm	160mm	160mm	170mm	170mm
手把贴片宽度	Handle Patch Width	52mm	52mm	52mm	52mm	52mm
手把贴片纸卷直径	Paper Patch Roll Diameter	Φ1200mm	Φ1200mm	Φ1200mm	Φ1200mm	Φ1200mm
手把贴片纸卷宽度	Paper Patch Roll Width	160mm	160mm	160mm	170mm	170mm
手把贴片纸克重	Paper Patch Thickness	70~110g/m ²	70~110g/m ²	70~110g/m ²	70~110g/m ²	70~110g/m ²
最大速度	Max. Speed	180bags/min(240bags/min)	180bags/min(220bags/min)	160bags/min	160bags/min(200bags/min)	120bags/min
机器功率	Total Power	29kw	29kw	29kw	29kw	29kw[34kw]
机器重量	Total Weight	Approx. 20000kg	Approx. 20000kg	Approx. 20000kg	Approx. 20000kg	Approx. 23000kg
外形尺寸	Overall Dimension	L16000 × W3500 × H3500mm	L16000 × W3500 × H3500mm	L15000 × W3500 × H3500mm	L16000 × W3500 × 3500mm	L16000 × W3500 × H3500mm

生产速度会因纸张和胶水的品质，以及操作人员的操作熟练程度而有所不同。
Production speed will be variable due to different paper, glue and operator's skill.

ZD-QFF14

双层卷筒纸全自动（扁绳）方底纸袋机

Dual-layer Fully Auto Roll-fed Square Bottom Paper Bag Machine with Flat Handle

NEW全球首创 Global First
智能操作 Intelligent Operation

Roll Paper W/O Handle Handle Sheet Paper Punching Top Folding Patch Handle



本机有别于传统的扁绳方底纸袋机，是制作高端带扁绳手把的方底纸袋的理想设备。该机由特异的机构制作扁绳，粘合在一层纸上或两层纸间，从而形成特殊的扁绳方底纸袋机。通过在一台机器上完成手把制作、手把黏贴、纸筒成型、纸筒切断和袋底成型等步骤，该机器真正实现了全自动化生产，能够有效节省人工成本。

Distinct from traditional square bottom paper bag machine with flat handle, this machine is an ideal equipment for making high-level paper bag with flat handle. This machine is able to apply the flat handles made by a special device, onto one layer of paper or between double layers of papers, so as to get a special paper bag with flat handle but without patch paper. By implementing steps including handle making, handle application, tube forming, tube cutting and bottom forming within a fully automatic process, this machine can effectively save labor costs.

特殊的机械和电气设计，可以一机生产多种扁绳纸袋，可以让客户在节省成本、市场主流需求和增加纸袋承重之间自由切换。

Special mechanical and electrical design makes this machine be able to produce various kinds of flat handle paper bags, which allows customers to switch freely between costs saving, mainstream market demand and bag load increasing.

Technical Data

主要技术参数

		ZD-QFF14
纸卷宽度	Paper Roll Width	630-1150mm(590-1150mm)
最大纸卷直径	Max.Paper Roll Diameter	Φ1200mm
基材卷芯内径	Material Core Diameter	Φ76mm(3")
原纸克重	Paper Thickness	70-125g/m ²
纸袋宽度	Bag Body Width	220-360mm(200-360mm)
纸筒长度	Paper Tube Length	350-600mm(350-650mm)
袋底宽度	Bag Bottom Size	80-200mm
手挽中心距	Handle Center Distance	330mm ≤ a ≤ 560mm
扁绳高度	Flat Handle Rope Height	80mm
扁绳宽度	Flat Handle Rope Width	18mm
扁绳纸卷宽度	Paper Rope Roll Width	80-85mm
扁绳纸卷直径	Paper Rope Roll Diameter	Φ1000mm
扁绳纸卷克重	Paper Rope Thickness	80-100g/m ²
手把贴片长度	Handle Patch Length	180mm
手把贴片宽度	Handle Patch Width	70mm
手把贴片纸卷直径	Paper Patch Roll Diameter	Φ1000mm
手把贴片纸卷宽度	Paper Patch Roll Width	180mm
手把贴片纸卷克重	Paper Patch Thickness	80-100g/m ²
最大速度	Max. Speed	140bags/min
机器功率	Total Power	56kw
机器重量	Total Weight	Approx. 22000kg
外形尺寸	Overall Dimension	L15000×W5500×H3600mm

生产速度会因纸张和胶水的品质，以及操作人员操作熟练程度而有所不同。
Production speed will be variable due to different paper, glue and operator's skill.

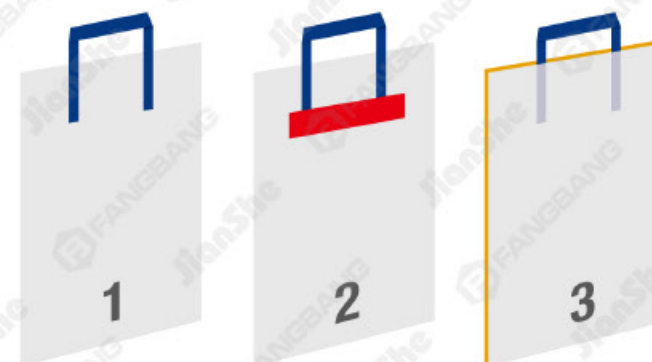

- 1 单张纸 + 扁绳
Single-layer Paper + Flat Rope
- 2 单张纸 + 扁绳 + 贴片
Single-layer Paper + Flat Rope + Patch Paper
- 3 双层纸 + 扁绳
Dual-layer Paper + Flat Rope

ZD-QFJ

卷筒纸全自动方底纸袋机

Fully Auto Roll-fed Square Bottom Paper Bag Machine



本机以卷筒纸、卷筒式头卡和纸绳为原料，一次性完成带手把的方底纸袋，是快速生产手提纸袋的理想设备。

通过在一台机器上完成手把制作、手把黏贴、纸筒成型、纸筒切断和袋底成型等步骤，该机器真正实现了全自动化生产，能够有效地节省人工成本。

光电眼自动修正切断长度，有效保证机器的切断精度。

西门子 PLC 系统和可调式双模板结构，既能确保整机能够快速稳定地运行，又能有效地减少纸袋尺寸调整的时间。

特别设计的收袋平台和计数功能，有效提高了用户批量打包成品的效率。

得益于完美的工艺和快速的制袋速度，

本机特别适用于食品和服装等行业的购物袋批量生产。

This machine is designed to manufacture square bottom paper bags with handles from paper roll, paper patch roll and paper rope, and it is an ideal equipment for producing paper handbags fast. By implementing steps including handle making, handle application, tube forming, tube cutting and bottom forming within a fully automatic process, this machine can effectively save labor costs. The equipped photoelectric detector can correct cutting length, so as to ensure cutting precision. SIEMENS PLC system and adjustable dual-moulds structure, ensure that the machine can perform quickly and stably, as well as reduce adjusting time for different bag sizes. Special bags collection platform and counting function, improve packing efficiency of finished paper bags. Thanks to perfect technologies and fast production speed, this machine can produce paper handbags with high quality in many different forms, which are especially suitable for food and clothing industries.

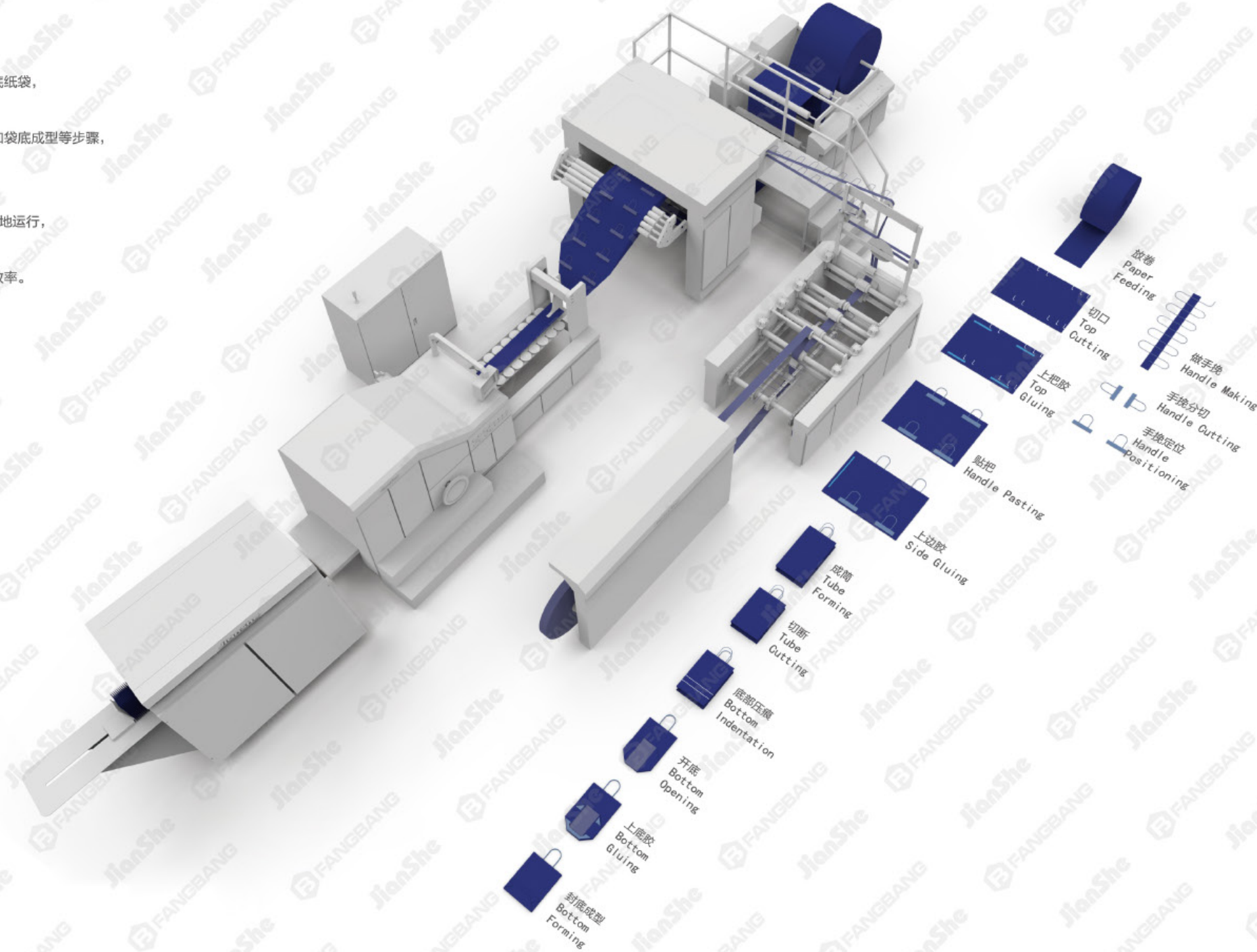

ZD-QFJ08 特殊的合底装置，改进了传统机型合底速度相对偏慢的缺点，从而大幅度提升机器的制袋速度。

Special bottom closing device of ZD-QFJ08 improves the relatively slow bottom closing process in traditional models, so as to greatly enhance the bag making speed.

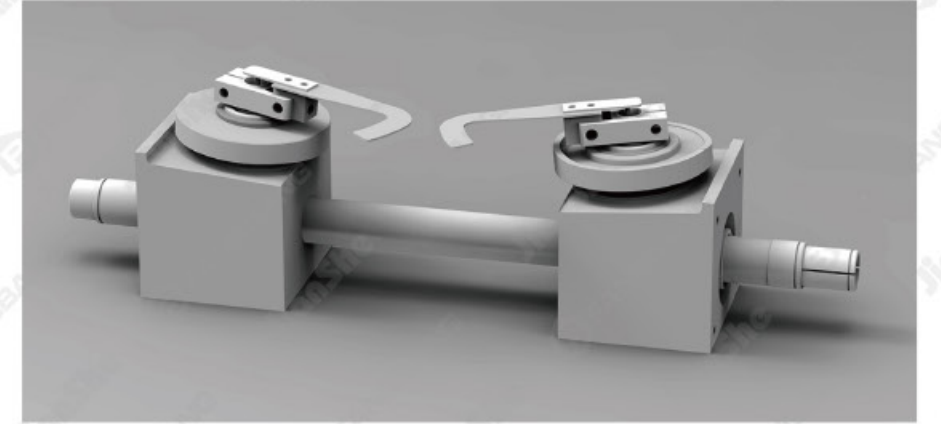

卓越的底部上胶（水胶）系统，可以有效节省胶水损耗和人工成本，让客户在生产中就获取利润。

Distinct bottom gluing system (water glue) can efficiently save glue loss and labor cost, bringing the profit to the customer directly during the production.

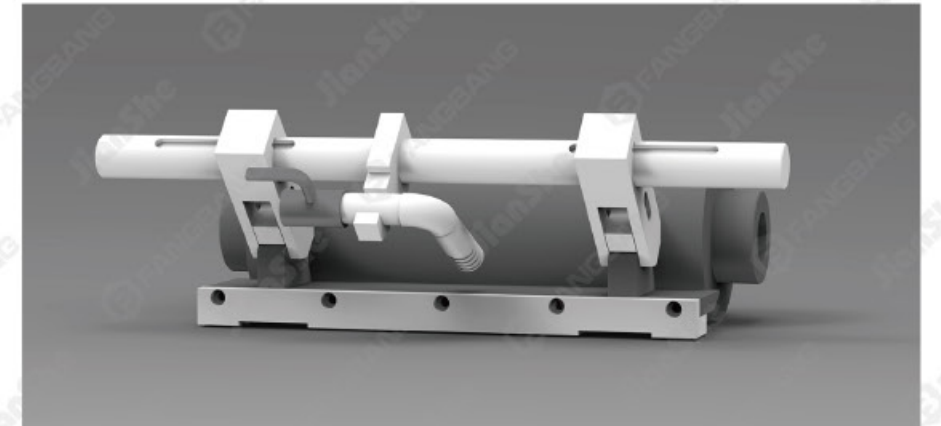

纸筒切断刀可自由切换为齿刀或平刀，可选配增加 J 型切刀和袋口反折功能，充分满足客户对不同袋口的生产需求。

Tube cutter can be equipped with serrated blade or straight blade freely, J-cutting & top folding function can be optional so as to meet customers' requirements to different bag mouths.



成型模板采用了对称可调式双模板结构（自有专利技术），对于不同尺寸的纸袋用户不再需要更换模板，能够有效地减少纸袋尺寸调整的时间并增加机器的产能。

Adjustable dual-moulds structure (own proprietary technology) is applied on the machine, so that users can adjust bag size directly on the machine, which greatly reduces bag size adjusting time and increase production capacity.



该类机器可以同时连线外置的圆绳手把机和扁绳手把机，不仅可节省 40% 以上的投资成本和 45% 以上的占地空间，而且一机两用，大大提高了客户的纸袋接单能力。

This kind of machine can be connected with independent twisted handle machine and flat handle machine at the same time, so that users can not only save at least 40% investment and 45% space, but also be more flexible to paper bag market due to one-machine-two-usages.



采用西门子 PLC 系统控制整机运行，可以在触摸屏上直接调整切断长度，让生产更加高效和稳定。

SIEMENS PLC system ensures that the adjustment of cutting length can be implemented directly on touch screen, meanwhile brings efficient and stable production.



手把可以内贴，用于常规纸袋；也可外贴，用于保温打包纸袋。

The handle can be applied inside the paper bag for being a normal handbag; in the other mode the handle can also be applied outside the paper bag for being an Insulated Take-away Paper Handbag.



最新机型 ZD-QFJ21M，可以高效生产夹边为 300mm 的方底手提纸袋，是放置披萨和甜品纸盒等物品的理想纸质容器。

Our latest model ZD-QFJ21M, can efficiently produce square bottom paper handbag with gusset 300mm, which is suitable for carrying boxes for pizza, dessert and so on.



TECHNICAL DATA

主要技术参数

	ZD-QFJ08C[F]	ZD-QFJ08[N]	ZD-QFJ11E	ZD-QFJ13E[S]	ZD-QFJ14[S]	ZD-QFJ18P	ZD-QFJ21S[M]	
纸卷宽度	Paper Roll Width	370~630mm	410~770mm[380~770mm]	590~890mm(370~890mm)	590~990mm(400~990mm)	590~1150mm	670~1390mm(590~1390mm)	630~1530mm [690~1710mm]
最大纸卷直径	Max. Paper Roll Diameter	Φ1500mm	Φ1500mm	Φ1500mm	Φ1500mm	Φ1500mm	Φ1500mm	Φ1500mm
基材卷芯内径	Material Core Diameter	Φ76mm(3")	Φ76mm(3")	Φ76mm(3")	Φ76mm(3")	Φ76mm(3")	Φ76mm(3")	Φ76mm(3")
原纸克重	Paper Thickness	45~140g/m ²	50~140g/m ²	50~150g/m ²	80~160g/m ²	80~150g/m ²	70~160g/m ²	80~170g/m ²
纸袋宽度	Bag Body Width	120~200mm	140~220mm[120~220mm]	200~280mm(110~280mm)	200~330mm(125~330mm)	200~360mm	240~460mm(200~460mm)	220~540mm
纸筒长度	Paper Tube Length	190~370mm[190~430mm]	215~370mm(215~470mm)	270~410mm(270~530mm)	270~420mm(270~530mm)	350~550mm(350~650mm)	350~520mm(280~620mm)	380~650mm(380~770mm)
袋底高度	Bag Bottom Size	50~100mm	50~140mm	60~150mm	60~150mm[70~180mm]	80~200mm[100~230mm]	80~220mm	80~254mm[110~300mm]
手把绳高	Handle Rope Height	90~95mm	80mm~85mm[90~95mm]	110~115mm	110~115mm	110~115mm	110~115mm	110~115mm
手把绳直径	Handle Rope Diameter	Φ3~4mm	Φ4~6mm[Φ3~4mm]	Φ4~Φ6mm	Φ4~Φ6mm	Φ4~Φ6mm	Φ4~Φ6mm	Φ4~Φ6mm
手把贴片长度	Handle Patch Length	96mm	114.3mm[96mm]	152.4mm	152.4mm	152.4mm	190.5mm	190.5mm
手把贴片宽度	Handle Patch Width	45~50mm	45~50mm	45~50mm	45~50mm	45~50mm	45~50mm	45~50mm
手把贴片纸卷直径	Paper Patch Roll Diameter	Φ1200mm	Φ1200mm	Φ1200mm	Φ1200mm	Φ1200mm	Φ1200mm	Φ1200mm
手把贴片纸卷宽度	Paper Patch Roll Width	90~100mm	90~100mm	90~100mm	90~100mm	90~100mm	90~100mm	90~100mm
手把贴片纸卷克重	Paper Patch Thickness	100~180g/m ²	100~180g/m ²	100~180g/m ²	100~180g/m ²	100~180g/m ²	100~180g/m ²	100~180g/m ²
最大速度	Max. Speed	200bags/min(220bags/min)	200bags/min(220bags/min)	180bags/min(220bags/min)	180bags/min(220bags/min)	160bags/min(150bags/min)	180bags/min(180bags/min)	110bags/min(120bags/min)
机器功率	Total Power	28kw	28kw	38kw	38kw	39kw	38kw	39kw[44kw]
机器重量	Total Weight	Approx.15000kg	Approx. 15000kg	Approx. 18000kg	Approx. 18000kg	Approx. 20000kg	Approx. 20000kg	Approx. 23000kg
外形尺寸	Overall Dimension	L11000 x W4400 x H1800mm	L11000 x W4400 x H1800mm	L14000 x W6000 x H3400mm	L14000 x W6000 x H3400mm	L14000 x W6000 x H3400mm	L14500 x W6000 x H3400mm	L14000 x W6000 x H3400mm

生产速度会因纸张和胶水的品质，以及操作人员的操作熟练程度而有所不同。
Production speed will be variable due to different paper, glue and operator's skill.

ZD-QFJ18N

全伺服卷筒纸全自动方底纸袋机

Fully Auto Roll-fed Square Bottom Paper Bag Machine (Full-servo)

NEW

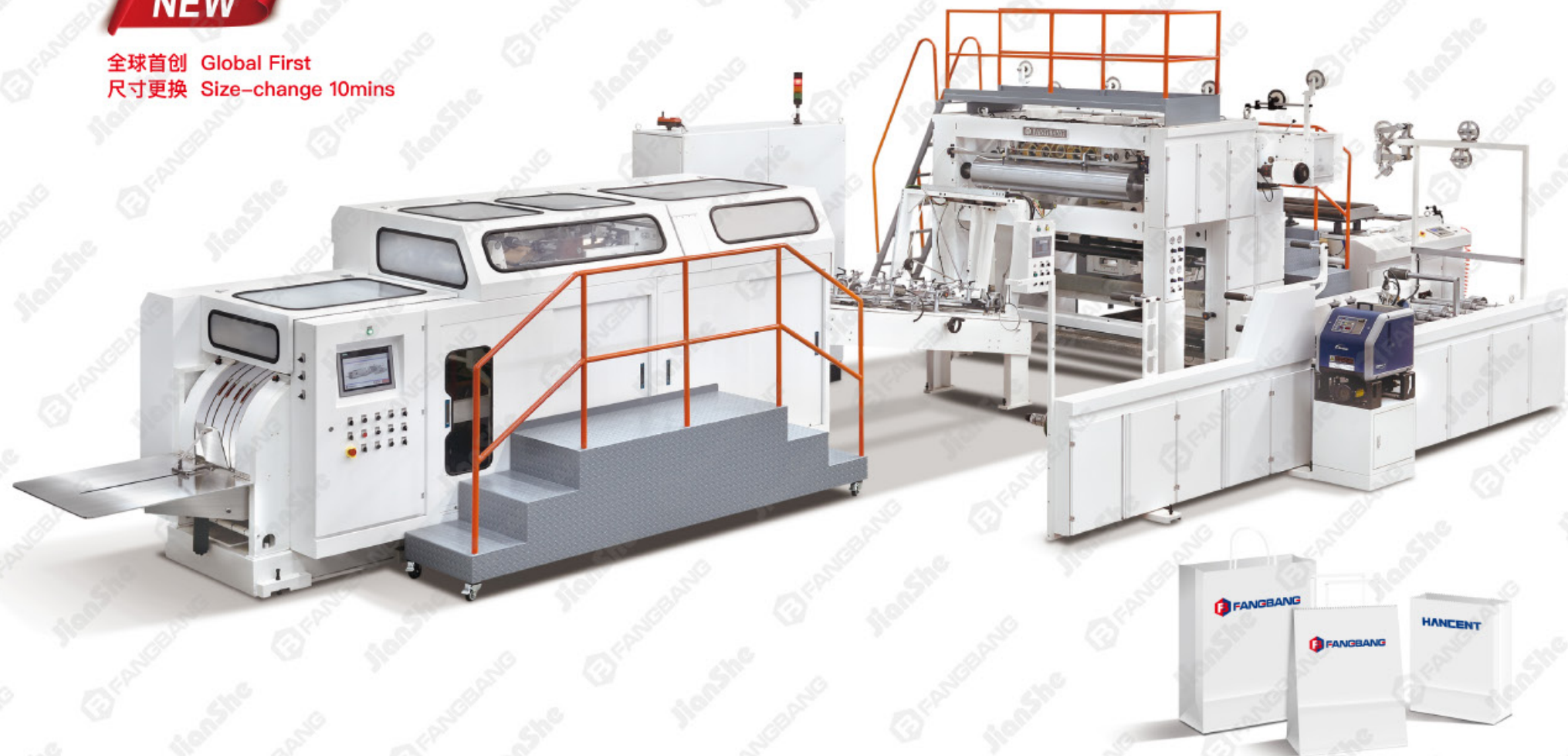
全球首创 Global First
尺寸更换 Size-change 10mins

Roll Paper W/O Handle Handle Sheet Paper Punching Top Folding Patch Handle

本机以卷筒纸、卷筒式头卡和纸绳为原料，一次性完成带手把的方底纸袋是快速生产手提纸袋的理想设备。通过在一台机器上完成手把制作、手把黏贴、纸筒成型、纸筒切断和袋底成型等步骤，该机器真正实现了全自动化生产，能够有效地节省人工成本。

This machine is designed to manufacture square bottom paper bags with handles from paper roll, and it is an ideal equipment for producing mid-size and big-size paper bags fast. By implementing steps including paper feeding, tube forming, tube cutting and bottom forming inline, this machine can effectively save labor costs.

Technical Data

主要技术参数

纸卷宽度	Paper Roll Width	550-1390mm(490-1390mm)
最大纸卷直径	Max.Paper Roll Diameter	Φ1500mm
基材卷芯内径	Material Core Diameter	Φ76mm(3")
原纸克重	Paper Thickness	80-150g/m ²
纸袋宽度	Bag Body Width	180-460mm(150mm-460mm)
纸筒长度	Paper Tube Length	300-530mm(280-570mm)
袋底宽度	Bag Bottom Size	80-220mm
手把绳高	Handle Rope Height	110mm-115mm
手把绳直径	Handle Rope Diameter	Φ4-6mm
手把贴片长度	Handle Patch Length	152.4mm
手把贴片宽度	Handle Patch Width	45-50mm
手把贴片纸卷直径	Paper Patch Roll Diameter	Φ1200mm
手把贴片纸卷宽度	Paper Patch Roll Width	90-100mm
手把贴片纸克重	Paper Patch Thickness	100-180g/m ²
最大速度	Max. Speed	150bags/min(180bags/min)
机器功率	Total Power	46kw
机器重量	Total Weight	Approx. 21000kg
外形尺寸	Overall Dimension	L14500xW6000xH3400mm

生产速度会因纸张和胶水的品质，以及操作人员操作熟练程度而有所不同。
Production speed will be variable due to different paper, glue and operator's skill.

ZD-QFJ18N



该机型制袋范围宽泛，可以一机满足目前市面上大部分的纸袋制造需求。可以同时连线外置的圆绳手把机和扁绳手把机，还能连线可内折的扁绳手把单元，一机多用，大大提高了客户的纸袋接单能力。

This kind of machine can be connected with independent twisted handle machine and flat handle machine all the same time, and inlaid flat handle as well. So that users can not only save at least 40% investment and 45% space, but also be more flexible to paper bag market due to one-machine-two-usages.



采用全伺服电机驱动设备，减少了手动调整的步骤，可以节省80%以上的调机时间；数字化智能控制，可以预设纸袋尺寸和制袋配方，大大提高生产效率。

Adopting fully servo motor driven equipment, reducing the steps of mechanical gear replacement and manual adjustment, Digitally and intelligently control the cutting length, and can preset the paper bag size and bag making formula. It reduces the adjustment time and improves production efficiency, it's an ideal equipment for producing handbags.



卷筒纸袋机 (半自动)
**ROLL-FED PAPER BAG
MACHINE (SEMI AUTO)**
适用于食品包装袋
Applicable for Food Bags



我们的纸袋每天与你见面
You use our paper bags every day

因为，一切的美好源于健康的生活
Because, all the best comes from healthy life

ZD-J20S/D

全伺服高速尖底纸袋机

Full-servo High Speed Flat Bottom Paper Bag Machine



Roll Paper 卷筒纸
W/O Handle 无手把
Handle 自动把手
Patch Handle 烫手把
Single Paper 单张纸
Punching 反折打
Top Folding 反折手把

本产品是中国首台真正的全伺服尖底纸袋机，通过 9 个高速伺服电机的高精度协同运行，该机器能够高速地一次性完成纸张放卷、喷胶贴膜、预刺孔、上边胶、成筒、拉断、底部涂胶、袋底成型、输送出袋等工序，生产出面向食品、药品等行业的尖底纸袋。该机拥有特殊的双线生产设计，让客户可以根据自己的需求，在生产效率和纸袋尺寸之间找到完美平衡点，是替代进口设备的理想选择。

As the first genuine Full-servo Flat Bottom Paper Bag Machine in China, this machine can make use of 9 high-speed and high-precision servo motors, to complete processes including paper unwinding, hot-melt glue spraying, film pasting, perforation, side gluing, tube forming, tube breaking, bottom gluing, bottom forming and bags collection at high speed. It produces flat & satchel paper bags not only for food industry, but also for medicine industry and other fast-consuming industries. Thanks to the special dual-line production design, this machine is an ideal alternative to imported equipment, for customers to find the perfect balance between production efficiency and bag size according to their various requirements.

Technical Data

主要技术参数

		ZD-J20S (单线 Single Line)	ZD-J20D (双线 Dual Lines)
最大纸卷宽度	Max. Paper Roll Width	1100mm	1100mm
最大纸卷直径	Max. Paper Roll Diameter	φ1300mm	φ1300mm
料卷卷芯内径	Material Core Diameter	φ76mm (3")	φ76mm (3")
材料克重	Material Thickness	Paper: 30-90g/m ² Cellophane: 40-90g/m ²	Paper: 30-90g/m ² Cellophane: 40-90g/m ²
纸筒长度	Tube Length	105-400mm	105-400mm
纸袋宽度	Bag Body Width	W/O Gusset: 60-500mm With Gusset: 60-500mm	W/O Gusset: 60-230mm With Gusset: 60-190mm
最大插边深度	Max. Gusset Depth	65mm	65mm
折底长度	Bottom Folding Length	15-25mm	15-25mm
最大速度	Max. Speed	1000bags/min	1800bags/min
机械总功率	Total Power	75kw	75kw
机器总重量	Total Weight	Approx. 5000kg	Approx. 5000kg
外形尺寸	Overall Dimension	L9000mm × W2500mm × H2100mm	L9000mm × W2500mm × H2100mm

生产速度会因纸张和胶水的品质，以及操作人员的操作熟练程度而有所不同。
Production speed will be variable due to different paper, glue and operator's skill.



国内首创真空模板，让薄纸在极速条件下依旧稳定成筒，为机器的高速运行提供强有力的保障。

As initiated inside China, the special designed vacuum forming mould ensures stable tube forming for thin paper at extremely high speed, which provides a strong guarantee for fast and stable flat & satchel paper bag making.

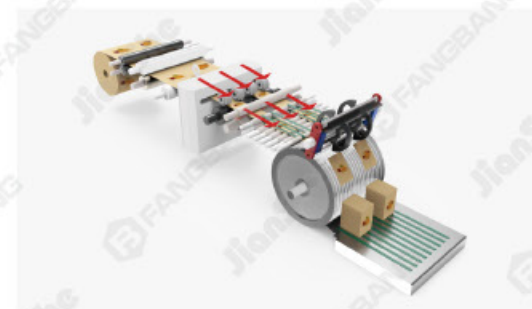

9 个西门子伺服高速和高精度同步作业，可双线生产纸袋，为客户带来至少 4 倍于传统机型的产量。

9 Siemens servo motors work synchronously at high speed and high precision, to ensure the capability of fast and stable dual-lane production, bringing customers more than 4 times as the output of traditional similar models.

ZD-J

卷筒纸尖底纸袋机

Roll-fed Flat Bottom
Paper Bag Machine

+W
Optional window unit
选配贴膜开窗单元

+T
Optional printing unit
选配印刷单元



本机用于卷筒原色纸或印刷卷筒纸，如牛皮纸、油光纸、医用纸等，

纸卷由纸袋工艺刺孔、中缝上胶、色标定长、原料成筒、定长扯断、底部折底、底部上胶。

袋底成形，成品袋整理一次完成。本机操作更方便，更高效，更稳定，

是生产各种不同纸质袋、开窗面包袋、休闲食品袋、面包袋、干果袋等环保纸袋的纸袋机设备。

This machine is designed to manufacture sharp bottom paper bag from paper roll, and it is suitable for kraft paper, ribbed kraft paper, grease-proof paper, coated paper, medico paper & etc. By implementing steps including roll feeding, side gluing, perforating, tube forming, tube cutting off, bottom folding and gluing, finished bag collecting within a fully automatic process, can effectively save labor costs. It has advantage of easy operation, high efficiency, more steady, it is an ideal machine for make different kind of paper bag, snack paper bag, food paper bag, bread paper bag, dry fruit paper bag and eco-friendly paper bag.

TECHNICAL DATA

主要技术参数

		ZD-J10	ZD-J13
纸卷宽度	Paper Roll Width	170~780mm	170~900mm
最大卷纸直径	Max. Paper Roll Diameter	Φ1000mm	Φ1000mm
基材卷芯内径	Paper Core Diameter	Φ76mm(3")	Φ76mm(3")
原纸克重	Paper Thickness	35~80g/m ²	35~80g/m ²
纸袋长度	Bag Body Length	100~450mm	120~710mm
纸袋宽度	Bag Body Width	80~250mm	80~320mm
纸袋夹边	Gusset Size	0~130mm	0~130mm
薄膜宽度	Film Width	50~200mm	50~200mm
薄膜厚度	Film Thickness	12~50um	12~50um
薄膜卷芯直径	Film Core Diameter	Φ76mm(3")	Φ76mm(3")
最大速度	Max. Speed	500bags/min	500bags/min
机器功率	Total Power	21kw	21kw
机器重量	Total Weight	Approx. 4500kg	Approx. 6500kg
外形尺寸	Overall Dimension	7000X1800X1900mm	7600X2200X2100mm

生产速度会因纸张和胶水的品质，以及操作人员操作熟练程度而有所不同。
Production speed will be variable due to different paper, glue and operator's skill.

1. 采用法国 Schneider 触摸屏人机界面，操作功能一目了然，便于掌控。
2. 采用英国 TRIO 运动控制器（PC），通过与光纤一体化，保证高速运行稳定。
3. 采用日本原装 Yaskawa 伺服电机搭配德国原装 SICK 光电眼修正，精确跟踪印刷袋尺寸。
4. 可选配开窗装置（包括薄膜放卷架和热熔胶机），增加透视开窗的功能，能更直观地展示袋中的商品。
5. 可选配印刷单元，无需增加印刷机的收放卷，节省工序转换时间和机器占地空间，有效实现自动化生产。

1. Machine use French Schneider touch screen human-computer interface, operation and control easily.
2. Adopt UK TRIO PC micro-computer control system, integrated with optical fiber, ensure high speed running steadily.
3. Adopt Japanese Yaskawa Servo Control System and German SICK photocell for rectify, tracking printed bag accurately.
4. Optional window making device including film unwinder and hot-melt glue system, can apply transparent window on one face of paper bag to display more clearly the goods inside.
5. Optional printing unit without unwinding/rewinding, saves operation time and physical space greatly, bringing more automation into traditional paper bag production.



ZD-FJ06

高速单规格方底纸袋机

Fast Fixed-size Square Bottom Paper Bag Machine

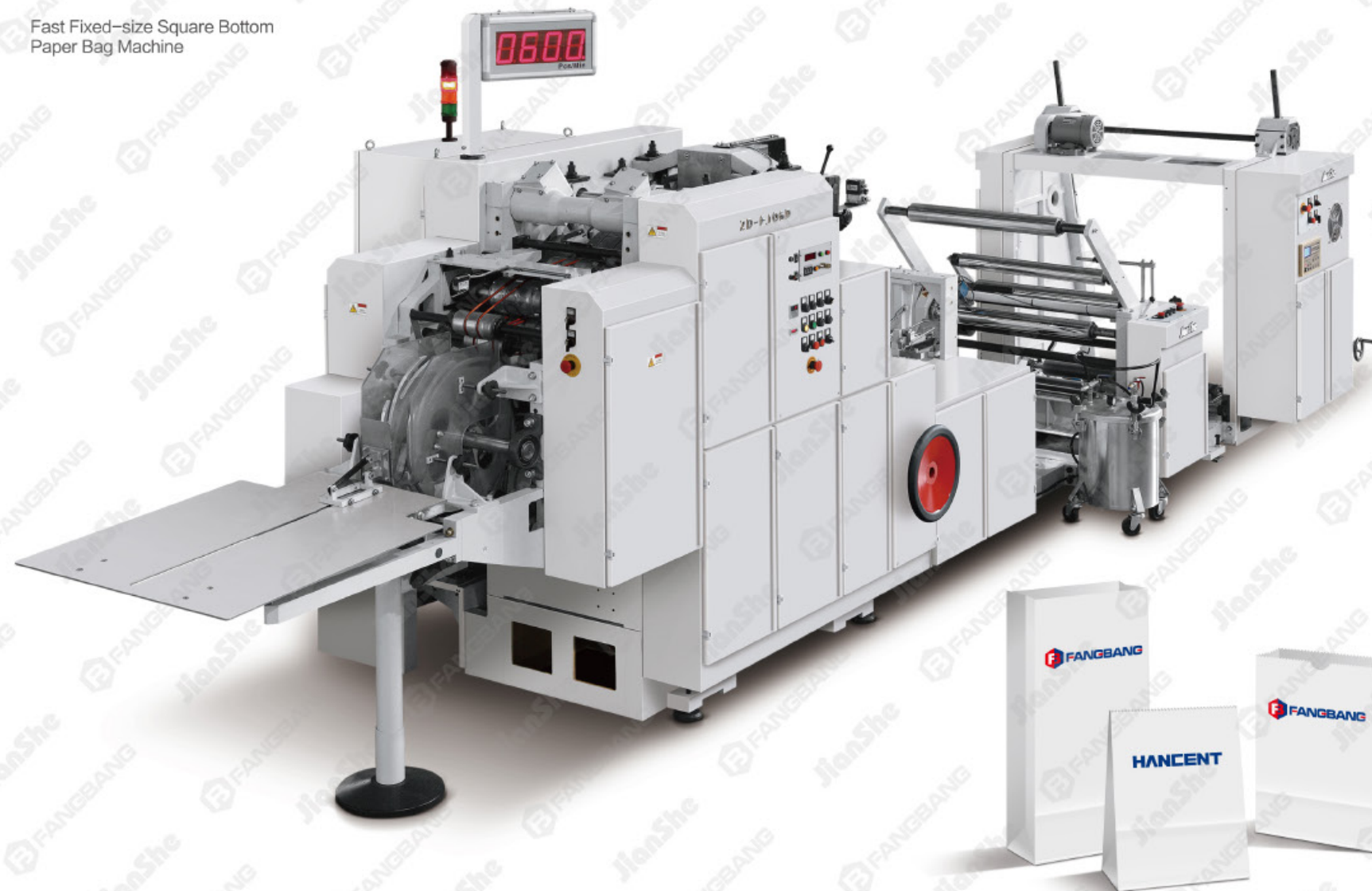

本机以卷筒纸为原料，一次性完成无手把的方底纸袋，是极速生产规格单一的小尺寸方底纸袋的理想设备。本机设计合理，结构紧凑，能够以不可思议的速度完成原纸输送、纸筒成型、纸筒切断和袋底成型等一系列复杂步骤，有效地节省人工成本。光电眼自动修正切断长度，有效保证机器的切断精度。配备了先进的西门子伺服系统，使得整机能够在不同的工作条件下依然保持稳定的性能。本机不仅能处理薄纸，而且制袋速度极快，特别适合用于食品行业的大规模纸袋生产。

As designed to produce square bottom paper bags without handles from roll paper, this machine is an ideal equipment for producing small fixed-size paper bags in extremely fast speed. This machine can implement steps including paper feeding, tube forming, tube cutting and bottom forming inline in incredible speed, so as to effectively save labor costs. The equipped photoelectric detector can correct cutting length automatically, so as to ensure cutting precision. The equipped SIEMENS PLC system ensures that the stable performance can be kept even if the machine is running in various working environments. This machine can process very thin paper, as well as produce paper bags exceedingly fast, thus this machine is especially suitable for being applied in massive productions of food industries.

TECHNICAL DATA

主要技术参数

ZD-FJ06

纸卷宽度	Paper Roll Width	535mm
最大纸卷直径	Max. Paper Roll Diameter	Φ1200mm
基材卷芯内径	Material Core Diameter	Φ76mm(3")
原纸克重	Paper Thickness	55-70g/m ²
纸筒长度	Tube Length	380mm
纸袋宽度	Bag Body Width	154mm
袋底宽度	Bag Bottom Size	100mm
最大速度	Max. Speed	500bags/min
机器功率	Total Power	8.4kw
机器重量	Total Weight	Approx. 5500kg
外形尺寸	Overall Dimension	L7500 × W2250 × H1800mm

生产速度会因纸张和胶水的品质，以及操作人员的操作熟练程度而有所不同。
Production speed will be variable due to different paper, glue and operator's skill.

该机器能以极快的速度生产无手把的纸袋，最高生产速度可达500个/分钟。

This machine can produce paper bags in extremely fast speed (500 pcs/min at MAX.).



该机器能够将薄纸加工成纸袋（纸的重量范围55-70g/m²）。

This machine can process thin paper for paper bags (paper thickness: 55-70g/m²).



ZD-FJ

卷筒纸方底纸袋机

Roll-fed Square Bottom Paper Bag Machine



本机以卷筒纸为原料，一次性完成无手把的方底纸袋，是快速生产各类不同尺寸方底纸袋的理想设备。
 本机设计合理，结构紧凑，能够快速完成原纸输送、纸筒成型、纸筒切断和袋底成型等一系列复杂步骤，有效地节省人工成本。
 光电眼自动修正切断长度，有效保证机器的切断精度。
 配备了先进的西门子 PLC 系统，使得整机能够快速稳定地运行。
 本机不仅能处理薄纸，而且制袋速度快，特别适合用于食品行业的纸袋生产。

This machine is designed to manufacture square bottom paper bags without handles from paper roll, and it is an ideal equipment for producing producing various sized paper bags fast. By implementing steps including paper feeding, tube forming, tube cutting and bottom forming inline, this machine can effectively save labor costs. The equipped photoelectric detector can correct cutting length, so as to ensure cutting precision. The equipped SIEMENS PLC system ensures that the machine can perform quickly and stably. This machine can process very thin paper, as well as produce paper bags very fast, thus this machine is especially suitable for being applied in food industries.

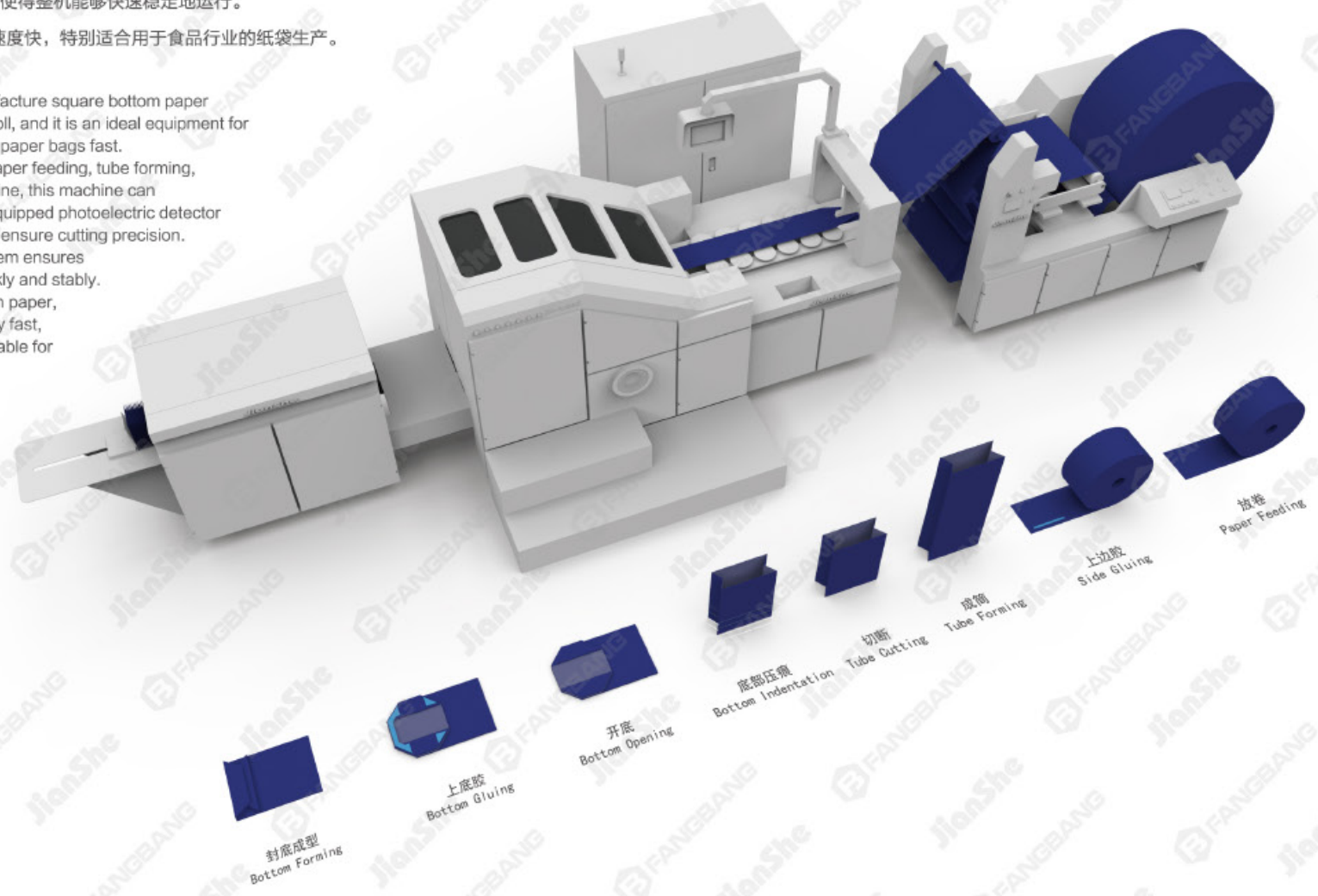

该机器的制袋尺寸范围很大，应用广泛。
 不仅可以生产小尺寸的食品袋，也可以生产大尺寸的购物袋。
 This machine can produce paper bags of wide-range sizes. It can produce not only small-size food bags, but also big-size shopping bags.



该机器可以根据客户的需求，制作拥有不同底部的纸袋。
 This machine can make various kinds of paper bags with different bottom styles.



TECHNICAL DATA

主要技术参数	ZD-FJ05	ZD-FJ08	ZD-FJ11E	ZD-FJ13E[S]	ZD-FJ14[S]	ZD-FJ18P[C]	ZD-FJ21S[M]	
纸卷宽度	Paper Roll Width	200-450mm	290-630mm	370-890mm	400-990mm[420-1050mm]	590-1150mm	590-1390mm[650-1280mm]	630-1530mm[690-1710mm]
最大纸卷直径	Max. Paper Roll Diameter	Φ1000mm	Φ1200mm	Φ1500mm	Φ1500mm	Φ1500mm	Φ1500mm	Φ1500mm
基材卷芯内径	Material Core Diameter	Φ76mm(3")	Φ76mm(3")	Φ76mm(3")	Φ76mm(3")	Φ76mm(3")	Φ76mm(3")	Φ76mm(3")
原纸克重	Paper Thickness	45-100g/m²	45-130g/m²	50-150g/m²	55-160g/m²	80-150g/m²	70-160g/m²	80-170g/m²
纸筒长度	Tube Length	130-350mm	190-370mm	270-530mm	270-530mm	340-650mm	280-620mm[380-760mm]	380-770mm
纸袋宽度	Bag Body Width	55-125mm	80-200mm	110-280mm	125-330mm	200-360mm	200-460mm[220-450mm]	220-540mm
袋底宽度	Bag Bottom Size	30-80mm	50-100mm	60-150mm	60-150mm[70-180mm]	80-200mm[100-230mm]	80-220mm[90-180mm]	80-254mm[110-300mm]
最大速度	Max. Speed	200bags/min	260bags/min	240bags/min	220bags/min	150bags/min	180bags/min	120bags/min
机器功率	Total Power	12kw	13.5kw	16kw	16kw[19kw]	18.5kw	18.5kw	18.5kw[23.5kw]
机器重量	Total Weight	Approx.5500kg	Approx. 6000kg	Approx. 8000kg	Approx. 8500kg	Approx. 11000kg	Approx. 11000kg	Approx. 14000kg
外形尺寸	Overall Dimension	L8000xW3000xH1600mm	L8500xW3000xH1600mm	L10000xW3300xH2000mm	L10000xW3450xH2000mm	L10500xW3500xH2000mm	L12000xW3500xH2000mm	L11600xW3500xH2000mm

生产速度会因纸张和胶水的质量，以及操作人员的操作熟练程度而有所不同。
 Production speed will be variable due to different paper, glue and operator's skill.

ZD-FJ+T+D+W+P**卷筒纸方底纸袋机(多功能选配)**

Roll-fed Square Bottom Paper Bag Machine
(Multi-functional Options)

通过在传统的纸袋机放料单元和成筒单元之间加入新的功能单元（柔版印刷、双层粘合、窗口模切或贴片冲孔），

该类机器真正实现了制袋和额外工艺之间的无缝连接，能够有效地减少设备投资和节省人工成本，让客户能够根据

市场的变化任意升级机器的功能。

By additionally embed functional unit (flexo printing, dual-layer pasting, die-cut window making or patching & punching) between the unwinding unit and tube forming unit in traditional paper bag machine, this kind of machine realizes the seamless connection between bag making and additional process, so as to effectively reduce equipment investment and save labor costs, meanwhile make the customer be more flexible to the rapidly changing market by upgrading machine functions.

该类机型是在传统纸袋机机型上作出的一次功能性扩展，以卷筒纸为原料，一次性完成无手把方底纸袋的制作，

是生产各类方底纸袋的理想设备。该类机型制袋尺寸范围广，制袋速度快，特别适用于食品和服装等行业的纸袋批量生产。

As a functional extension of traditional model of paper bag machine, this kind of machine can make paper bags without handles inline from paper roll, thus it is an ideal equipment for producing printed paper bags fast. This kind of machine can produce paper bags of varying greatly sizes at a high speed, thus it is especially suitable for being applied in food and clothing industries.

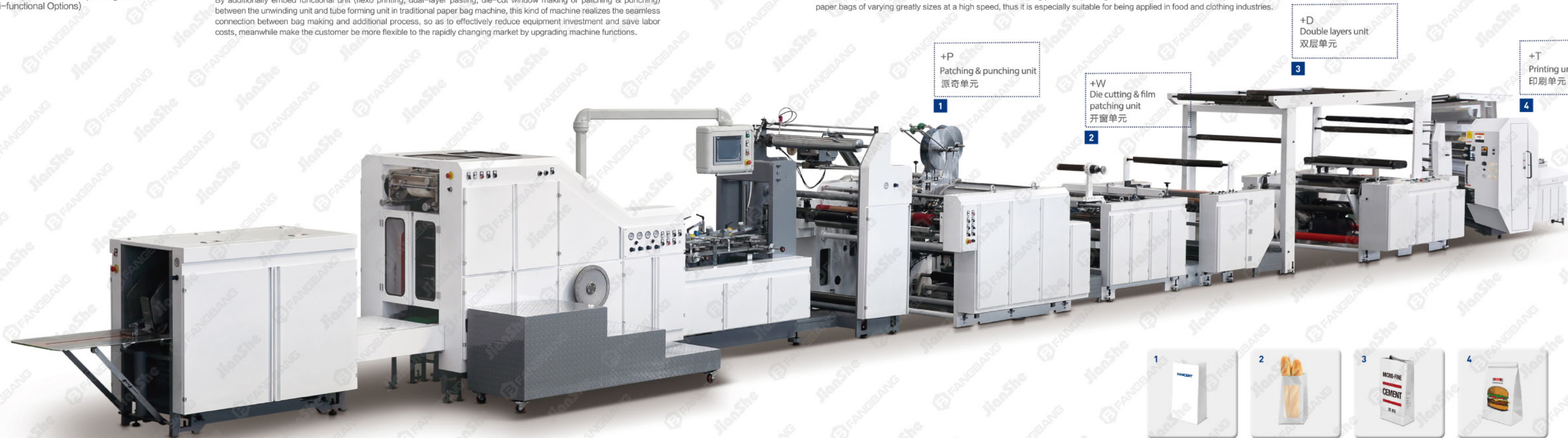

+P
Patching & punching unit
派奇单元

1

+W
Die cutting & film
patching unit
开窗单元

2

+D
Double layers unit
双层单元

3

+T
Printing unit
印刷单元

4



ZD-FJ21+PE+S

卷筒纸快递纸袋机

Roll-fed E-commerce Paper Bag Machine

NEW

全球首创 Global First
一机多用 Multiple Functions



本机在传统的卷筒纸袋机上，做出了特殊的功能拓展，使得机器可以生产特殊的用于运输轻型商品的快递纸袋。
本机功能强大，操作简单，可以高效稳定地连线完成舌口模切、袋底成型和离型纸/易撕条黏贴等工艺，有效地减少人工成本，为客户创造更多价值。
This machine derives from the traditional roll-fed paper bag machine by adding special function, which makes itself be able to make special e-commerce paper bags for shipping light merchandise. This machine is multi-function and easy-operation, and it can efficiently and stably implement processes including flap die-cut, bottom forming and peel&seal strip/tear strip pasting, which can save the labor cost markedly and create more values for customers.



TECHNICAL DATA 主要技术参数

	V-bottom with Flap 尖底带舌口	Square Bottom with Flap 方底带舌口	Cross Bottom with Flap 六角底带舌口	Square Bottom w/o Flap 方底
纸卷宽度 Paper Roll Width	630-1530mm	630-1530mm	630-1530mm	630-1530mm
最大纸卷直径 Max. Paper Roll Diameter	Φ1500mm	Φ1500mm	Φ1500mm	Φ1500mm
基材卷芯内径 Material Core Diameter	Φ76mm (3")	Φ76mm (3")	Φ76mm (3")	Φ76mm (3")
原纸克重 Paper Thickness	80-130g/m ²	80-130g/m ²	80-130g/m ²	80-170g/m ²
纸筒长度 Tube Length	380-770mm	380-770mm	380-770mm	380-770mm
纸袋宽度 Bag Body Width	220-540mm	220-540mm	300-540mm	220-540mm
袋底宽度 Bag Bottom Size	/	80-210mm	80-110mm	80-210mm
夹边宽度 Gusset Size	0, 40-130mm	80-210mm	/	80-210mm
舌口高度 Flap Height	50-120mm	50-130mm	50-120mm	/
最大速度 Max. Speed	100bags/min	100bags/min	100bags/min	120bags/min
机器功率 Total Power	52.5kw	52.5kw	52.5kw	52.5kw
机器重量 Total Weight	Approx. 16000kg	Approx. 16000kg	Approx. 16000kg	Approx. 16000kg
外形尺寸 Dimension(L*W*H mm)	14000 × 7000 × 2000mm	14000 × 7000 × 2000mm	14000 × 7000 × 2000mm	14000 × 7000 × 2000mm



ZD-FJ21+PC

卷筒纸快递纸袋机

Roll-fed E-commerce Paper Bag Machine

NEW

全球首创 Global First
低成本高效 Low-cost & High-profit



本机在传统的卷筒纸袋机上，做出了特殊的功能拓展，使得机器可以生产特殊的用于运输轻型商品的快递纸袋。
本机功能强大，操作简单，可以高效稳定地连线完成舌口成型、袋底成型和离型纸/易撕条黏贴等工艺，有效地减少人工成本，为客户创造更多价值。

This machine derives from the traditional roll-fed paper bag machine by adding special function, which makes itself be able to make special e-commerce paper bags for shipping light merchandise. This machine is multi-function and easy-operation, and it can efficiently and stably implement processes including flap forming, bottom forming and peel&seal strip/tear strip pasting, which can save the labor cost markedly and create more values for customers.

TECHNICAL DATA 主要技术参数

	Square Bottom with Flap 方底带舌口	Cross Bottom with Flap 六角底带舌口	Square Bottom w/o Flap 方底
纸卷宽度 Paper Roll Width	630-1530mm	630-1530mm	630-1530mm
最大纸卷直径 Max. Paper Roll Diameter	Φ1500mm	Φ1500mm	Φ1500mm
基材卷芯内径 Material Core Diameter	Φ76mm (3")	Φ76mm (3")	Φ76mm (3")
原纸克重 Paper Thickness	80-130g/m ²	80-130g/m ²	80-170g/m ²
纸筒长度 Tube Length	420-720mm	420-720mm	420-720mm
纸袋宽度 Bag Body Width	220-540mm	300-540mm	220-540mm
袋底宽度 Bag Bottom Size	80-210mm	80,90,100,110mm	80-210mm
舌口高度 Flap Height	customized	customized	/
最大速度 Max. Speed	120bags/min	120bags/min	120bags/min
机器功率 Total Power	64kw	64kw	64kw
机器重量 Total Weight	18000kg	18000kg	18000kg
外形尺寸 Dimension(L*W*H mm)	17000 × 7000 × 2000mm	17000 × 7000 × 2000mm	17000 × 7000 × 2000mm





柔版印刷机

FLEXOGRAPHIC PRINTING MACHINE

适用于纸张、无纺布印刷

Applicable for Printing on Paper or Nonwoven Fabrics



不经意间，就会发现我们机器的产物
Inadvertently, you will find products from our machines

这，就是柔版印刷机的魅力所在
This, is the charm of flexographic printing machine



YT-E

高速机组式柔版印刷机

High Speed
Unit-type Flexo Printing Machine

NEW



该机是以柔性感光树脂版、橡胶版为基材，通过网纹辊传墨，用液体油墨对承印物进行印刷的印刷机。

该机一般由放料单元、张力控制单元、牵引送料单元、印刷单元、干燥单元、收卷牵引单元及收料单元等主要机组组成，整机由 PLC 系统集中控制。

该机结构合理、运印速度快、操作简单，是目前世界范围内理想的纸印设备。

This machine is a printing machine which adopts flexible photosensitive resin plates, rubber plates as the base material, anilox rollers for transferring ink, liquid ink for printing. It is controlled centrally by PLC system and generally consists of unwinding section, tension control section, infeed traction section, printing section, drying section, outfeed traction section, rewinding section and control section. This machine is an ideal machine for printing paper cup, carton, paper bag and so on.

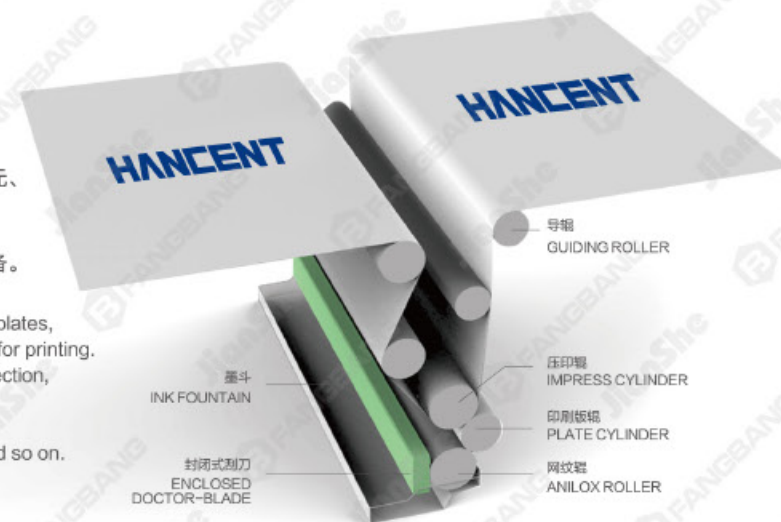
TECHNICAL DATA
主要技术参数

		YT-1000E	YT-1300E	YT-1500E
原纸克重	Paper Thickness	40~320g/m ²	40~320g/m ²	40~320g/m ²
最大料卷宽度	Max. Material Roll Width	1050mm	1350mm	1550mm
最大印刷宽度	Max. Printing Width	1000mm	1300mm	1500mm
印刷重复长度	Printing Repeat Length	381~1500mm	381~1500mm	381~1500mm
最大放卷直径	Max. Unwinding Diameter	φ1500mm	φ1500mm	φ1500mm
最大收卷直径	Max. Rewinding Diameter	φ1500mm	φ1500mm	φ1500mm
齿轮规格	Gearing Specification	1/8 CP	1/8 CP	1/8 CP
套准精度	Registration Accuracy	±0.1mm	±0.1mm	±0.1mm
最大速度	Max. Speed	300m/min	300m/min	300m/min
导纸辊直径	Guiding Roller Diameter	φ120mm	φ120mm	φ120mm
干燥形式	Drying Mode	热风干燥和红外干燥 Warm Drying and I.R. Drying		

生产速度会因纸张和墨水的品质，以及操作人员操作熟练程度而有所不同。
Production speed will be variable due to different paper, ink and operator's skill.

YT-D

机组式柔版印刷机

Unit-type
Flexo Printing Machine



该机是以柔性感光树脂版、橡胶版为基材，通过网纹辊传墨，用液体油墨对承印物进行印刷的印刷机。

该机一般由放料单元、张力控制单元、牵引送料单元、印刷单元、干燥单元、收卷牵引单元及收料单元等主要机组组成，整机由 PLC 系统集中控制。

该机结构合理、运印速度快、操作简单，是目前世界范围内理想的纸印设备。

This machine is a printing machine which adopts flexible photosensitive resin plates, rubber plates as the base material, anilox rollers for transferring ink, liquid ink for printing. It is controlled centrally by PLC system and generally consists of unwinding section, tension control section, infeed traction section, printing section, drying section, outfeed traction section, rewinding section and control section. This machine is an ideal machine for printing paper cup, carton, paper bag and so on.

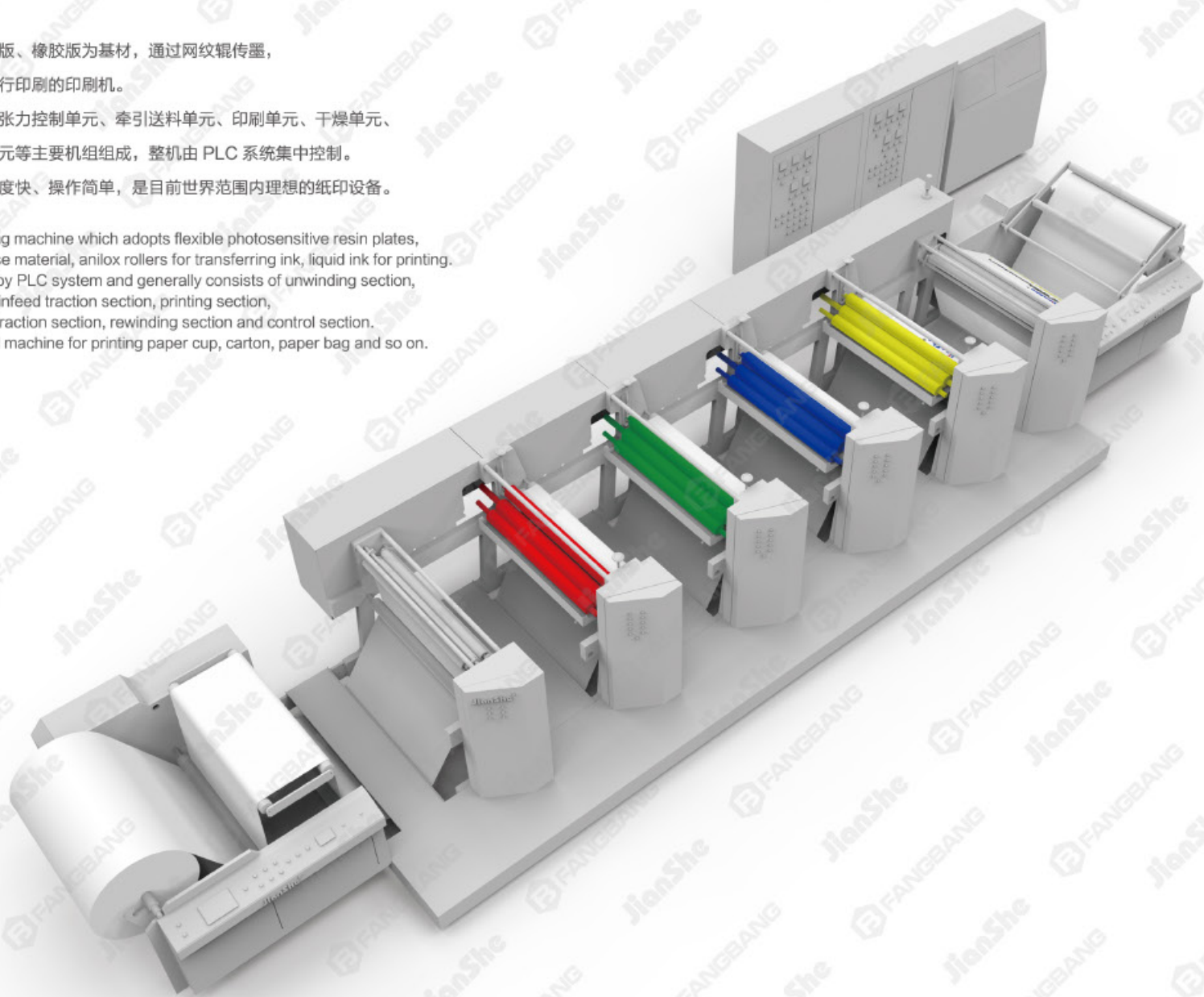

采用网纹辊输墨系统结构，有效保证印刷质量。
Anilox roller inking structure effectively guarantees printing quality.

机器适应性强，从“牛皮纸”到瓦楞纸板都可以获得满意的印刷效果。
The machine has strong adaptability, since it can achieve satisfactory printing effect on various materials, from kraft paper to corrugated board.

机组加装组合灵活方便，可以根据用户的不同需求增加或减少机组数量。
The combination of printing units is flexible, because users can increase or decrease printing unit number according to different requirements.

制版费用低，印刷过程中损纸率低，能够有效降低机器的印刷成本，较凹印便宜至少 30-50%。
Low-cost printing plate and Low-loss printing process can effectively reduce printing cost, which is 30-50% lower than gravure printing.

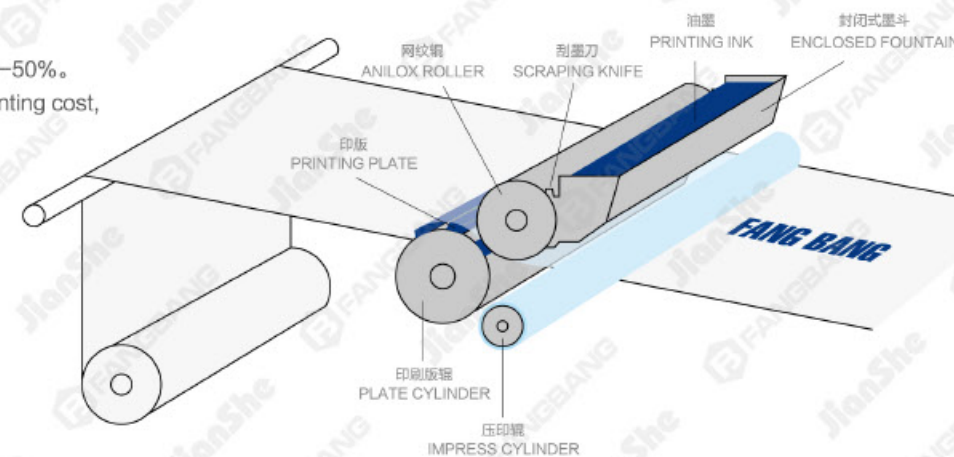

TECHNICAL DATA

主要技术参数		YT-1000C/D	YT-1300C/D	YT-1500C/D
原纸克重	Paper Thickness	40~220 or 220~380g/m ²	40~220 or 220~380g/m ²	40~220 or 220~380g/m ²
最大料卷宽度	Max. Material Roll Width	1020mm	1320mm	1520mm
最大印刷宽度	Max. Printing Width	1000mm	1300mm	1500mm
印刷重复长度	Printing Repeat Length	285~1200mm(380~1500mm)	285~1200mm(380~1500mm)	380~1500mm
最大放卷直径	Max. Unwinding Diameter	φ 1500mm	φ 1500mm	φ 1500mm
最大收卷直径	Max. Rewinding Diameter	φ 1500mm	φ 1500mm	φ 1500mm
齿轮规格	Gearing Specification	1/8 CP	1/8 CP	1/8 CP
套准精度	Registration Accuracy	± 0.12mm	± 0.12mm	± 0.12mm
最大印刷速度	Max. Printing Speed	150m/min	150m/min	150m/min
导纸辊直径	Guiding Roller Diameter	φ 100mm	φ 100mm	φ 100mm
主电机功率	Main Motor Power	11kw	15kw	18.5kw
干燥形式	Drying Mode	热风干燥和红外干燥 Warm Drying and I.R. Drying		

生产速度会因纸张和墨水的品质，以及操作人员操作熟练程度而有所不同。
Production speed will be variable due to different paper, ink and operator's skill.

YT-CB

双伺服机组式柔版印刷机

Dual-servo
Unit-type Flexo Printing Machine

NEW



该机使用柔性感光树脂版、橡胶版为基材，通过网纹辊传墨，用液体油墨对承印物进行印刷的印刷机。

该机一般由放料单元、张力控制单元、牵引送料单元、印刷单元、干燥单元、收卷牵引单元及收料单元等主要机组组成，整机控制由PLC集中控制。该机结构合理、运印速度快、操作简单，是目前国内理想的纸印设备。

This machine is a printing machine which adopts flexible photosensitive resin plates, rubber plates as the base material, anilox rollers for transferring ink, liquid ink for printing. It is controlled centrally by PLC system and generally consists of unwinding section, tension control section, infeed traction section, printing section, drying section, outfeed traction section, rewinding section and control section. This machine is an ideal machine for printing paper cup, carton, paper bag and so on.

Technical Data

主要技术参数

		YT-1000CB	YT-1300CB	YT-1500CB
原纸克重	Paper Thickness	60-280g/m ²	60-280g/m ²	60-280g/m ²
最大纸幅宽度	Max.Material Roll Width	1020mm	1320mm	1520mm
最大印刷宽度	Max. Printing Width	1000mm	1300mm	1500mm
印版重复长度	Printing Repeat Length	350-1200mm	350-1200mm	350-1200mm
最大放卷直径	Max.Unwinding Diameter	Φ1500mm	Φ1500mm	Φ1500mm
最大收卷直径	Max.Rewinding Diameter	Φ1500mm	Φ1500mm	Φ1500mm
纸芯内径	Material Core Diameter	Φ76mm(3")	Φ76mm(3")	Φ76mm(3")
套准精度	Registration Accuracy	±0.1mm	±0.1mm	±0.1mm
最大机械速度	Max. speed	220m/min	220m/min	220m/min
导纸辊直径	Guiding Roller Diameter	Φ120mm	Φ120mm	Φ120mm
干燥形式	Drying Mode	热风干燥和红外干燥 Warm Drying and I.R. Drying		

生产速度会因纸张和胶水的品质，以及操作人员的操作熟练程度而有所不同。
Production speed will be variable due to different paper, glue and operator's skill.

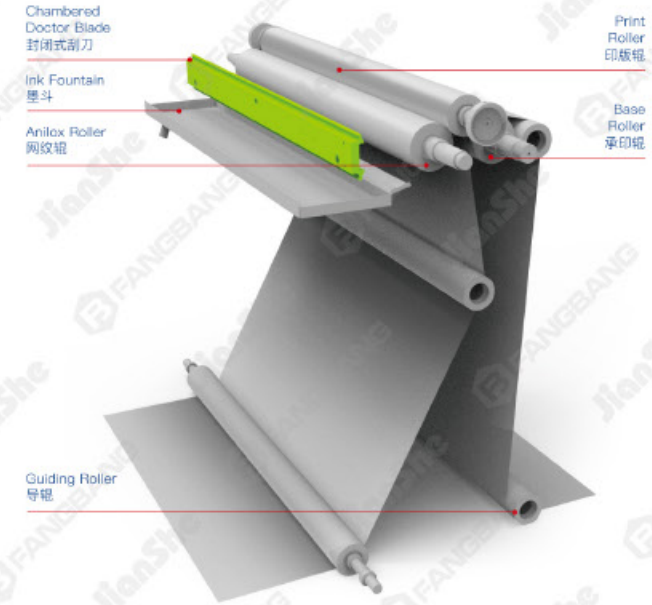

YT-BE

层叠式柔版印刷机

Stack-Type
Flexo Printing Machine

1. 整机由 PLC 触摸屏控制，确保稳定的生产性能。
2. 气动起落印版辊，印版辊升起后电机自动匀墨。
3. 可靠的干燥系统，配合高速运转，在停机可自动断路。
4. 高精度行星齿轮 360° 连续纵向对花，配合同步电机点动式装置，使印刷效果更细腻。
5. 配备陶瓷网纹辊（封闭式金属刮刀）或者金属网纹辊（封闭式塑料刮刀），以及墨泵循环。

1. The whole machine is controlled by PLC, ensuring stable production performance.
2. The lifting up and down of printing cylinder is controlled pneumatically; printing ink will be stirred by motor when the printing cylinder lifts up.
3. Adopts reliable drying system coordinated with high-speed rotation, which will automatically break circuit when the machine stops.
4. High-precision planetary gear ensuring 360° continuous longitudinal color registration, coordinated with motor-driven jogging device, makes printing effect more exquisite.
5. Equipped with ceramic anilox roller with chambered doctor metal blade (or metal anilox roller with chambered doctor plastic blade), as well as ink pump circulation.

TECHNICAL DATA

主要技术参数

	YT-800BE	YT-1000BE	YT-1300BE	YT-1500BE	
最大料卷宽度	Max. Material Roll Width	800mm	1000mm	1300mm	1500mm
最大印刷宽度	Max. Printing Width	760mm	960mm	1260mm	1460mm
最大收放卷直径	Max. Un/Rewinding Diameter	Φ1500mm	Φ1500mm	Φ1500mm	Φ1500mm
印刷重复长度	Printing Repeat Length	200~900mm	200~900mm	200~900mm	200~900mm
套准精度	Registration Accuracy	±0.2mm	±0.2mm	±0.2mm	±0.2mm
最大印刷速度	Max. Printing Speed	100m/min	100m/min	100m/min	100m/min
干燥形式	Drying Mode	热风干燥 Warm Drying			

生产速度会因纸张和墨水的品质，以及操作人员的操作熟练程度而有所不同。
Production speed will be variable due to different paper, ink and operator's skill.

该机是以柔性感光树脂版、橡胶版为基材，通过网纹辊传墨，用液体油墨对承印物进行印刷的层叠式印刷机。得益于传统的机器结构，本机特别适合印刷于聚乙烯、玻璃纸和卷筒纸等包装材料，是生产食品包装、超市手提袋、马甲袋和服装袋等包装的理想印刷设备。

This machine is a traditional stack-type printing machine which adopts flexible photosensitive resin plates, rubber plates as the base material, anilox rollers for transferring ink, liquid ink for printing. Thanks to the traditional machine structure, this machine is suitable for printing on packaging materials such as polyethylene, cellophane and roll paper, etc. It is an ideal printing equipment for producing food packaging, supermarket handbag, vest bag and clothes bag, etc.



YT-BC

层叠式柔版印刷机

Stack-Type
Flexo Printing Machine

TECHNICAL DATA

主要技术参数

	YT-800BC	YT-1000BC	YT-1300BC	YT-1500BC	
最大料卷宽度	Max. Material Roll Width	800mm	1000mm	1300mm	1500mm
最大印刷宽度	Max. Printing Width	760mm	960mm	1260mm	1460mm
最大收放卷直径	Max. Un/Rewinding Diameter	Φ1500mm	Φ1500mm	Φ1500mm	Φ1500mm
印刷重复长度	Printing Repeat Length	230~1000mm	230~1000mm	230~1000mm	230~1000mm
套准精度	Registration Accuracy	±0.3mm	±0.3mm	±0.3mm	±0.3mm
最大印刷速度	Max. Printing Speed	100m/min	100m/min	100m/min	100m/min
干燥形式	Drying Mode	热风干燥 Warm Drying			

生产速度会因纸张和墨水的品质，以及操作人员的操作熟练程度而有所不同。
Production speed will be variable due to different paper, ink and operator's skill.

该机是以柔性感光树脂版、橡胶版为基材，通过网纹辊传墨，用液体油墨对承印物进行印刷的层叠式印刷机。得益于传统的机器结构，本机特别适合印刷于聚乙烯、玻璃纸和卷筒纸等包装材料，是生产食品包装、超市手提袋、马甲袋和服装袋等包装的理想印刷设备。

This machine is a traditional stack-type printing machine which adopts flexible photosensitive resin plates, rubber plates as the base material, anilox rollers for transferring ink, liquid ink for printing. Thanks to the traditional machine structure, this machine is suitable for printing on packaging materials such as polyethylene, cellophane and roll paper, etc. It is an ideal printing equipment for producing food packaging, supermarket handbag, vest bag and clothes bag, etc.

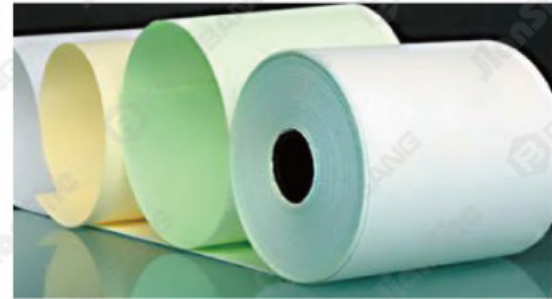
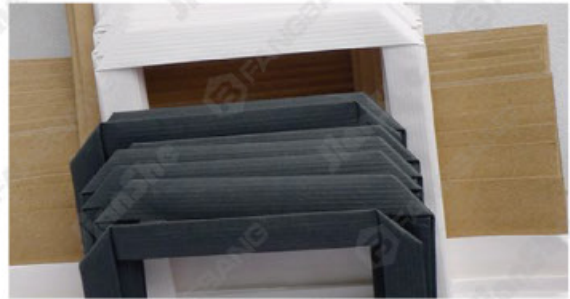

辅助设备
**AUXILIARY
 EQUIPMENTS**
 与纸袋机配套
 Supporting Paper Bag Machine



她们不是主角，您才是主角
 You are the leading role, rather than them

这，会成为您的得力助手
 But they will be your right-hand



ZD-SB100

高速手把机

High Speed Paper Handle Machine

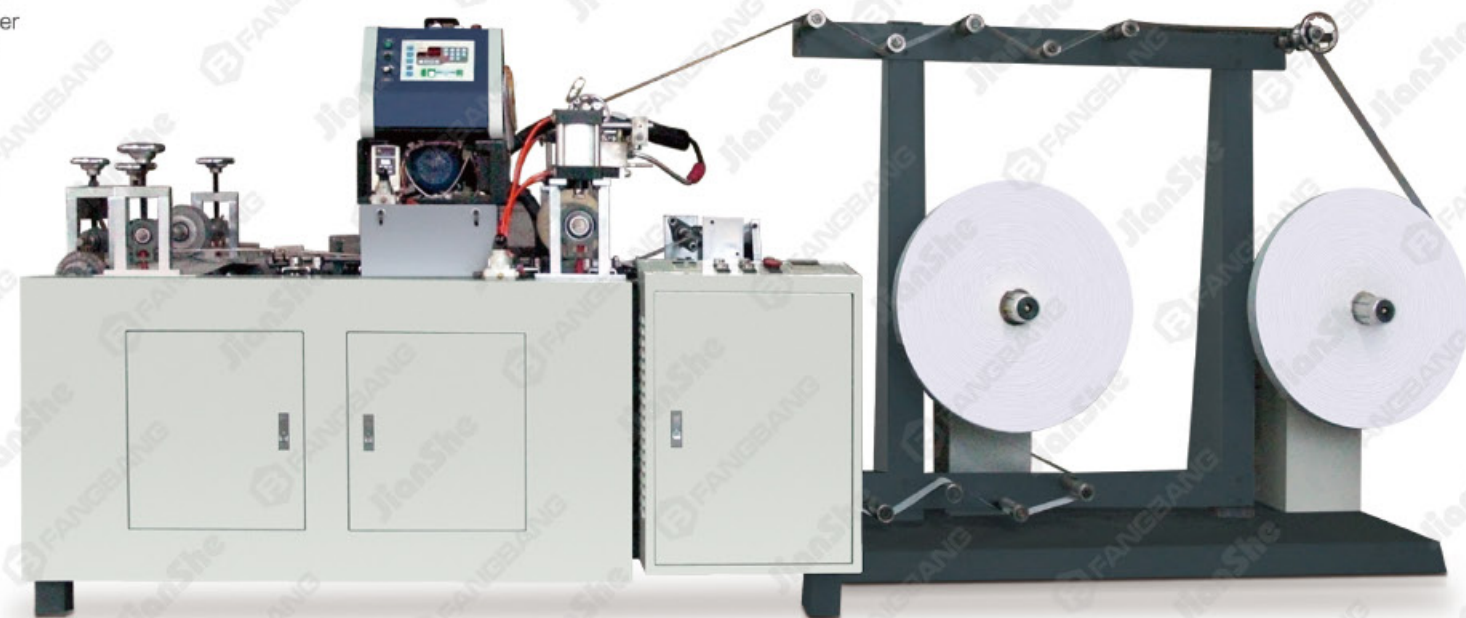
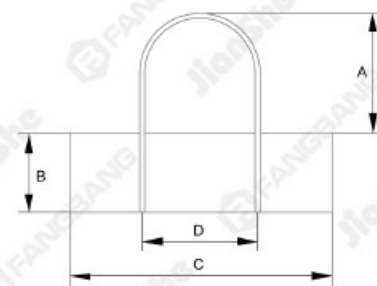
手把规格
Handle Specification

(A) 手把绳高	Rope Height	100mm
(B) 贴片宽度	Patch Width	40mm
(C) 贴片长度	Patch Length	152/190mm
(E) 纸绳间距	Rope Spacing	76/95mm

TECHNICAL DATA

主要技术参数

ZD-SB100A(圆绳 TWISTED HANDLE)

纸卷内径	Paper Roll Core Diameter	φ76mm(3")
最大纸卷外径	Max. Paper Roll Diameter	φ1000mm
生产速度	Production Speed	7000pairs/hour
电源需求	Power Requirements	380V, 50Hz, 3 phases, 5 wires
机器功率	Total Power	5.1kw
机器重量	Total Weight	Approx. 1500kg
外形尺寸	Overall Dimension	L4700 × W1300 × H1600mm

生产速度会因纸张和胶水的品质，以及操作人员的操作熟练程度而有所不同。
Production speed will be variable due to different paper, glue and operator's skill.

该机器主要配套半自动纸袋机使用，能够快速生产圆绳和扁绳手把，后期可通过人工将手把黏贴到纸袋上，使之变为手提袋。

该机器以两卷窄幅卷筒纸和一卷纸绳为原料，通过将卷筒纸片和纸绳黏贴在一起并逐步切断，从而形成手把。此外该机器也有自动计数和自动上胶的功能，能极大地提高用户后续加工作业效率。

This machine is mainly supporting semi-automatic paper bag machines. It can quickly produce paper handle with twisted rope, which can be attached onto the paper bag without handles in further production and make it into paper handbags. This machine takes two narrow paper rolls and one paper rope as raw material, sticks paper belts and paper rope together, which will be cut off gradually to form paper handles. In addition, the machine also has automatic counting and gluing functions, which can greatly improve the efficiency of subsequent processing operations of users.

手把成品自动上胶功能，有效提高后续纸袋加工效率。

Automatic paper handle gluing function speeds up subsequent paper bag processing.

可选配 10 米工作平台，方便后续纸袋机加工作业。

Optional 10-meter conveyer belt brings convenience for further paper bag processing.

有两种不同配置，可选配水胶装置或者热熔胶装置。

Two different gluing configurations: water glue system or hot-melt glue system.

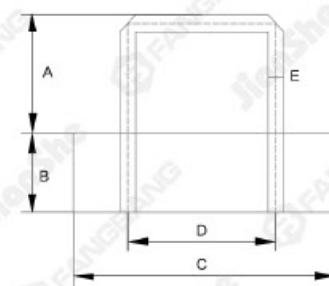
手把规格
Handle Specification

(A) 手把绳高	Flat Rope Height	100/103mm
(B) 贴片宽度	Handle Patch Width	40mm
(C) 贴片长度	Flat Patch Length	152/190mm
(D) 纸绳间距	Flat Rope Spacing	93/96mm
(E) 扁绳宽度	Flat Rope Width	12/15mm

TECHNICAL DATA

主要技术参数

ZD-SB100B(扁绳 FLAT HANDLE)

纸卷内径	Paper Roll Core Diameter	φ76mm(3")
最大纸卷外径	Max. Paper Roll Diameter	φ800/1000mm
生产速度	Production Speed	6000pairs/hour
电源需求	Power Requirements	380V, 50Hz, 3 phases, 5 wires
机器功率	Total Power	10kw
机器重量	Total Weight	Approx. 4000kg
外形尺寸	Overall Dimension	L5000 × W1500 × H1500mm

生产速度会因纸张和胶水的品质，以及操作人员的操作熟练程度而有所不同。
Production speed will be variable due to different paper, glue and operator's skill.



ZD-YS300**绕绳机**Twisted Paper Rope
Machine

该机器主要配套高速手把机和纸袋机使用，能够快速生产圆形纸绳，从而为高速手把机提供原料。该机器以窄幅卷筒纸为原料，通过机器轴心的高速旋转，使纸条扭转成绳，并以绳卷的形式保存。用户可以调节纸绳的直径，从而满足自己不同的生产需求。该机器也可以根据客户需求，定制升级版机型，即一台机器上能够同时制作两卷纸绳，从而大大提高生产效率。

This machine is mainly supporting high-speed paper handle machine and paper bag machine. It can quickly produce circular paper rope, so as to provide raw materials for paper handle machine. This machine takes narrow paper roll as raw material, and twists the paper into rope through the fast rotating shaft and keeps the final product in the roll pattern. According to users' different requirements, they can adjust the paper rope diameter directly, as well as customize the special model of this machine, which can simultaneously produce two paper rope rolls on one machine, thus greatly improve production efficiency.

TECHNICAL DATA

主要技术参数		ZD-YS300	ZD-YS300D
纸卷内径	Paper Roll Core Diameter	76mm (3")	76mm (3")
最大纸卷外径	Max. Paper Roll Diameter	800mm	800mm
纸卷宽度	Paper Roll Width	30-100mm	30-100mm
原纸克重	Paper Thickness	25-60g/m ²	25-60g/m ²
纸绳直径	Paper Rope Diameter	φ2.5-6mm	φ2.5-6mm
绳卷内径	Rope Roll Core Diameter	90mm	90mm
最大绳卷外径	Max. Rope Roll Diameter	300mm	300mm
最大绳卷宽度	Max. Rope Roll Width	300mm	300mm
生产速度	Production Speed	16-20m/min	30-40m/min
电源需求	Power Requirements	380V, 50HZ, 3PH	380V, 50HZ, 3PH
机器功率	Total Power	1.1kw	1.5kw
机器重量	Total Weight	Approx. 500kg	Approx. 750kg
外形尺寸	Overall Dimension	L1800 × W1100 × H1000mm	L1800 × W1500 × H1000mm

生产速度会因纸张品质，以及操作人员的操作熟练程度而有所不同。
Production speed will be variable due to different paper, and operator's skill.

ZD-FJ200**圆绳复卷机**Twisted Paper Rope
Rewinding Machine

该机器主要配套绕绳机使用，能够将目标绳卷快速复卷一遍，确保纸绳能够持续流畅地应用到手把生产作业中。该机器一般以绕绳机的产品绳卷为原料，通过机器轴心的高速旋转，将绳卷在一端快速释放并在另一端缠绕一遍，既能扩大最终绳卷的外径，又能消除原有绳卷中可能存在的打结现象，从而确保纸绳的使用效率在后续的生产应用中大大提高。

This machine is mainly supporting twisted paper rope machine. It is applicable to rewind the target paper rope roll, to ensure that the rope can be applied in further productions successfully. This machine takes the paper rope roll produced from twisted paper rope machine as the raw material, releases the roll on one shaft and twines it on the other shaft on the machine. This machine can not only enlarge the diameter of the paper rope roll, but also eliminate rope knots in the raw paper rope roll, so that the application efficiency of paper rope roll can be greatly improved in further productions.

TECHNICAL DATA

主要技术参数		ZD-FJ200
原绳卷内径	Core Diameter of Raw Rope Roll	90mm
最终绳卷内径	Core Diameter of Final Rope Roll	180mm
最终绳卷外径	Final Rope Reel Diameter	400-600mm
最终绳卷高度	Final Rope Reel Height	380mm
最大生产速度	Max. Production Speed	150m/min
电源需求	Power Requirements	380V, 50Hz, 3 phases, 5 wires
机器功率	Total Power	2.2kw
机器重量	Total Weight	Approx. 120kg
外形尺寸	Overall Dimension	L1050 × W800 × H1200mm

生产速度会因纸张品质，以及操作人员的操作熟练程度而有所不同。
Production speed will be variable due to different paper, and operator's skill.

FQ-1400/1700/1900

卷筒纸分切机

Roll-fed Sheet Cutter



该机器主要配套柔版印刷机和单张纸纸袋机使用，能够快速将柔版印刷机印好的纸卷分切成单张纸，为单张纸纸袋机提供原料。本机电脑控制系统采用国际品牌—汇川伺服电机及 AC 变频器、输送带采用尼塔 (NITTA)、气动振动器采用瑞士菲迪瓦 (FINDEVA)、电气系统采用施耐德与欧姆龙，使切纸速度更快且稳定；德国精密轴承及切断刀，切断精度高；轻触式电脑界面控制，操作简便；构造合理的反曲架，保证纸张的平坦。作为目前造纸业及印刷业中普遍采用的纸品加工机械，本机自投放市场以来，以其运行可靠，价格低廉，维修方便和良好的售后服务获得广大用户信赖与好评。

The machine is mainly supporting flexographic printing machine and sheet-fed paper bag machine. It can cut the printed paper roll from flexographic printing machine into sheet paper, which can be used as the material of sheet-fed paper bag machine. The machine is equipped with YASKAWA servo motor and AC converter for computer control system, adopts NITTA conveyor belt, FINDEVA pneumatic vibrator and SCHNEIDER/OMRON electrical system, to ensure cutting quickly and stably; Bearing and cutters from Germany, ensure high cutting precision; Touch screen computer interface control, brings simple operations; Anti-curved frame with proper structure, ensures flat sheet paper. As widely adopted in the printing and packaging industry, this machine has advantages including stable performance and low price, so that obtains trust and praise from customers.

TECHNICAL DATA

主要技术参数

FQ-1400/1700/1900A

主要技术参数	FQ-1400/1700/1900A	
切纸形式	Paper Cutting Pattern	上刀回切, 下刀固定 The upper knife cut reciprocally and the lower knife is fixed
最大纸卷宽度	Max. Paper Roll Width	1400mm/1700mm/1900mm
最大纸卷直径	Max. Paper Roll Diameter	Φ1800mm
原纸克重	Paper Thickness	60-550g/m ² (100-1000g/m ² 双回旋转刀 Double rotary sheeter)
切断长度范围	Cutting Length Range	450-1450mm
剖纸幅数	Slitting Format	2 sheets
切断精度	Cutting Precision	切断长度 < 1000mm: ±0.5mm 切断长度 > 1000mm: ±0.1% cutting length < 1000mm: ±0.5mm cutting length > 1000mm: ±0.1%
最高切断速度	Max. Cutting Speed By Cut	300cuts/min
最高切断米速	Max. Cutting Speed By Meter	300m/min
最大堆纸高度	Max. Paper Pile Height	1300mm
气源要求	Air Source Requirements	0.8MPa
电源要求	Power Requirements	380V/220V, 50Hz
机器重量	Total Weight	13000/10500/17000kg

生产速度会因纸张品质，以及操作人员的操作熟练程度而有所不同。
Production speed will be variable due to different paper, and operator's skill.

FT-1100A/1300A/1600A

卷筒纸分条机

Roll-fed Slitting Machine



该机器主要配套柔版印刷机、卷筒纸纸袋机和手把机等设备使用，能够以卷筒纸为原料，快速纵向分切原料，从而生成更窄的卷筒纸料。本机采用了光电自动跟踪纠偏、磁粉张力控制、自动计长等多项技术，选用先进的光电传感系统和全自动电气控制程序，是目前国内外较完善的纸张加工设备。除了纸张之外，本机也适用于塑料薄膜、玻璃纸、铝箔、化纤织物等卷筒料的纵向分切，以供复膜、包装、印刷和制袋等使用。

The machine is mainly supporting the flexographic printing machine, roll-fed paper bag machine and paper handle machine, etc. It is able to slit paper roll fast in the vertical direction, to produce narrower paper rolls. As a perfect paper processing equipment all over the world, this machine adopts advanced technologies including automatic photoelectric tracking correction, magnetic powder tension control, automatic measuring, photoelectric sensor system and automatic electrical control program. In addition to paper, this machine is also applicable to process plastic film, glass paper, aluminum foil, glass fiber fabric, for coating, packaging, printing and bag making, etc.

TECHNICAL DATA

主要技术参数

主要技术参数	FT-1100A	FT-1300A	FT-1600A	
原纸克重	Paper Thickness	40-300g/m ²	40-300g/m ²	40-300g/m ²
放卷卷芯内径	Material Core Diameter	Φ76mm(3"), Φ152mm(6")	Φ76mm(3"), Φ152mm(6")	Φ76mm(3"), Φ152mm(6")
收卷卷芯内径	Final Material Core Diameter	Φ76mm(3")	Φ76mm(3")	Φ76mm(3")
最大放卷宽度	Max. Unwinding Width	1100mm	1300mm	1600mm
最大放卷直径	Max. Unwinding Diameter	Φ1500mm	Φ1500mm	Φ1500mm
最大收卷直径	Max. Rewinding Diameter	Φ1000mm/Φ1200mm	Φ1000mm/Φ1200mm	Φ1000mm/Φ1200mm
最大分切宽度	Max. Slitting Width	1100mm	1300mm	1600mm
最小分切宽度	Min. Slitting Width	30mm	30mm	30mm
最大生产速度	Max. Production Speed	350m/min	350m/min	350m/min
电源需求	Power Requirements	380V, 50HZ, 3PH	380V, 50HZ, 3PH	380V, 50HZ, 3PH
机器功率	Total Power	22kw	24kw	28kw
气源需求	Air Source Requirements	0.8MPa	0.8MPa	0.8MPa
外形尺寸	Overall Dimension	L4300 X W3200 X H2000mm	L4300 X W3400 X H2000mm	L4300 X W3700 X H2000mm
机器重量	Total Weight	5800kg	6200kg	6600kg

生产速度会因纸张品质，以及操作人员的操作熟练程度而有所不同。
Production speed will be variable due to different paper, and operator's skill.

无论我们的客户在哪里，
我们都能够提供强有力的技术支持和**完善的售后服务**，
为他们创造所期望的价值。

作为一家集研发、生产、销售和服务于一体的高新技术企业，

方邦机械始终将机器质量放在第一位，始终关注着用户。

我们坚持把高质量的材料、先进的设计、精益求精的加工、

认真仔细的装配调试和严格的制造标准及质量保证体系紧密结合在一起，

制造出令客户满意的产品。

No matter where our customers are,
we are able to provide strong technical support and perfect after-sale service,
to create the desired value for them.

As a high-tech enterprise including research, development, production, sales and service,
Jiangsu Fangbang Machinery always places machine quality in the first place and pays attention onto customers.
We insist on combining high-quality materials, advanced design, refined processing,
aborative assembling and testing,
strict manufacturing standards and stringent quality assurance system together,
to manufacture satisfactory products for customers.



FANGBANG
SERVICE

24小时服务热线

+86-512-6579 1888

如今，我们已离不开您，甚至更在乎您

Now, we can not be without you, even care more about you

